

PERSISTENT PURSUIT OF QUALITY AND PERFORMANCE

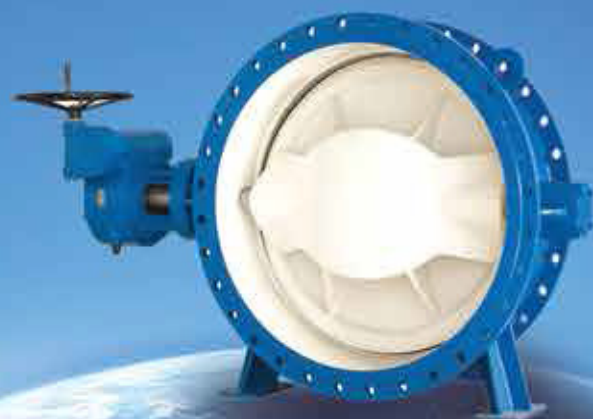

We aim to provide best services to all valuable customers with quality products and technical expertise.



EXPERT IN PROCESS VALVE

阀门编号与选型

Model establishment method

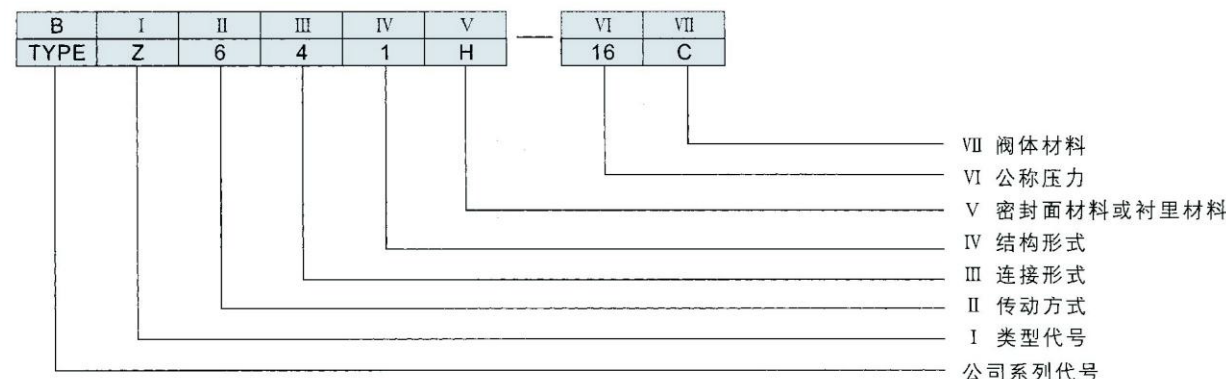

代号	0	1	2	3	4	5	6	7	8	9
II-传动方式	电磁动	电磁-液动	电-液动	蜗轮	正齿轮	锥齿轮	气动	液动	气-液动	电动
III-连接形式	-	内螺纹	外螺纹	-	法兰	-	焊接	对夹	卡箍	卡套
I-类型代号	IV-结构形式									
闸阀	Z	明杆				暗杆				-
		楔式		平行式		楔式		平行式		
截止阀	J	弹性闸阀				平衡				-
		单闸板		双闸板		直通式		直角式		
节流阀	L	-	直通式	Z型式	三通式	角式	直流式	-	-	-
柱塞阀	U	-	-	-	-	-	-	-	-	-
球阀	Q	半球直通	浮动球			固定式			三通式	
			直通式	三通式Y形	-	三通式	四通式	直通式	Y形	T形
蝶阀	D	非密封型 三偏心	密封型				非密封型			
			中线式	单偏心	双偏心	连杆机构	三偏心	中线式	单偏心	双偏心
隔膜阀	G	-	屋脊式	-	截止式	-	直流式	直通式	角式Y形	-
旋塞阀	X	-	填料密封			油密封			-	
			直通式	T形三通式	四通式	直通式	T形三通式	-	-	-
止回阀	H	-	升降式		旋启式		回转蝶形		截止止回	-
			直通式	立式	角式	单瓣式	双瓣式	多瓣式	-	-
安全阀	A	带散热片 全启式	弹簧封闭		弹簧不封闭	弹簧封闭	弹簧不封闭			脉冲式
			微启式	全启式	带扳手	带控制 全启式	微启式	全启式	-	
减压阀	Y	-	薄膜式	弹簧薄膜式	活塞式	波纹管式	杠杆式	-	-	-
疏水阀	S	-	浮球式	-	浮桶式	膨胀式	钟形浮子式	膜盒式	双金属片式	脉冲式
排污阀	P	-	液面连续排放		液面间断排放		浮动闸板型			
			直通式	角式	-	-	直流式	直通式	角式	-

VI-公称压力 公称通径的数值用10倍的兆(MPa)数表示;用于电站工业的阀门,当介质最高温度超过425℃时,标注工作压力。

V-阀座密封面 或衬里材料	代号	V-阀座材料	代号
巴氏合金	B	尼龙塑料	N
搪瓷	C	渗硼钢	P
渗氮钢	D	衬铅	Q
氟塑料	F	Mo2Ti系不锈钢	R
陶瓷	G	塑料	S
Cr13系不锈钢	H	铜合金	T
衬胶	J	橡胶	X
蒙乃尔合金	M	硬质合金	Y

VII-阀座材料	代号	VII-阀座材料	代号
钛及钛合金	TI	球墨铸铁	Q
碳钢	C	Mo2Ti系不锈钢	R
Cr13系不锈钢	H	塑料	S
铬钼钢	I	铜及铜合金	T
可锻铸铁	K	铬钼钒钢	V
铝合金	L	灰铸铁	Z
18-8系不锈钢	P	-	-

注: 1、由阀门直接加工的阀座密封面材料代号用“W”表示;
2、除隔膜阀外,当密封材料不同时,用低硬度材料代号表示。

注: 1、PN < 1.6MPa的灰铸铁阀体和PN > 2.5MPa的碳素钢阀体材料可省略本代号;
2、CF3、CF8、CF3M、CF8M等材料牌号可直接标注在阀体上。

蝶阀材料使用指南

Guide for use of butterfly valve materials

阀板分析 Valve disc analysis

部件名称 Part name	材料名称 Material name	适应尺寸 Meet size	PH值 Value	氯含量 Chlorine (ppm)	适用温度 Applicable temperature	材质优点 Material advantage	应用介质 Application medium
蝶板 Disc	SAF2507超级双项钢、表面质量S3 SAF2507 Super Dual-steel, the surface quality of S3	DN40~1200	>3.0	<30.000	<35~150℃	特耐磨、耐腐蚀、宜高流速冲击 Special wear and corrosion resistance, high velocity impact should	石灰石浆液、石膏浆液、洗涤浆液、Gypsum浆液、工艺水、废水等。 Limestone, gypsum slurry, washed slurry, Gypsum slurry, process water and waste water.
	DIN1.4529超级双项不锈钢 Super stainless steel double-entry		>5.0	<5.000			
	C276耐腐蚀镍基合金表面质量S3 C276 corrosion-resistant nickel-base hard alloy surface quality S3		>2.5	<50.000			
	Hostalen Gur		>5.0	<5.000		耐腐蚀 Corrosion	工艺水、废水等 Process water, wastewater, etc.

阀座分析 Valve seat analysis

部件名称 Part name	材料名称 Material name	适应尺寸 Meet size	PH值 Value	氯含量 Chlorine (ppm)	适用温度 Applicable temperature	材质优点 Material advantage	应用介质 Application medium
阀座 (阀衬) Valve seat (valve lining)	CSM弹性胶 Flexible plastic	DN40~1200	>0	<150.000	<35~150℃	耐磨、耐腐蚀 Wear and corrosion resistance	石灰石浆液、石膏浆液、洗涤浆液、Gypsum浆液、工艺水、废水等。 Limestone, gypsum slurry, washed slurry, Gypsum slurry, process water and wastewater.
	EPDN 三元乙丙橡胶		>2.5				

阀门金属材质、非金属材质、耐腐蚀耐温推荐表

Valve metal materials, non-metallic materials, corrosion resistant temperature recommended table

材料 Material	适用温度(°C) Suitable temperature	介质及适用程度 Media and the applicability											特征 Feature	
		淡水 Fresh water	海水 Sea water	强碱 Alkali	弱碱 Weak base	强酸 Strong acid	弱酸 Weak acid	醇 Alcohol	空气 Air	蒸汽 Steam	油 Oil	食物 Food		
阀座 Seat	NBR	-23~93℃	A	A	B	A	D	B	C	A	D	A	B	抗油 Resistant oil
	EPDM	-46~135℃	A	A	A	A	C	A	B	A	A	C	A	抗老化 Anti-aging
	NR	-20~85℃	A	A	A	A	C	B	C	A	B	B	B	高弹性 High elasticity
	CR	-29~99℃	A	B	A	A	D	C	C	A	D	D	B	耐磨、抗老化 Wear-resistant, anti-aging
	SI	-55~180℃	A	B	D	B	D	B	B	A	A	C	C	抗高温 Resistant to high temperatures
	FPM	-23~200℃	A	A	C	A	C	A	C	A	A	A	A	防腐、抗高温 Anti-corrosion, anti-high temperature
	PTFE	-20~180℃	A	A	A	A	A	A	A	A	A	A	A	防腐所有化学介质 Anticorrosive all chemical media
阀板 Disc	电镀球铁 Plating ductile iron	-30~350℃	B	C	D	C	D	C	A	B	B	A	C	抗热 Thermal
	PA	-30~100℃	A	A	A	A	D	A	C	A	D	A	A	防腐、抗碱性 Anti-corrosion, anti-alkaline
	PCR	-30~140℃	A	A	A	A	A	A	A	A	C	A	A	防腐、抗酸 Corrosion, acid-fast
	PTFE	-20~180℃	A	A	A	A	A	A	A	A	A	A	A	防腐、所有化学介质 Corrosion, all chemicals
	PFA	-20~180℃	A	A	A	A	B	A	A	A	A	A	A	防腐、抗高温 Anti-corrosion, anti-high temperature
	不锈钢 Stainless steel	-252~316℃	A	C	C	B	C	B	A	A	A	A	A	防腐、抗高温 Anti-corrosion, anti-high temperature
铝青铜 Aluminum bronze	-212~232℃	A	C	C	C	D	C	A	A	A	A	C	抗热、抗通常温度 Heat resistance, resistance usual temperature	
钛 Titanium	-196~550℃	A	A	A	A	C	B	A	A	A	A	A	防腐、抗高温 Anti-corrosion, anti-high temperature	

注: A-非常适用, B-适用, C-有限适用, D-不适用。Note: A-Very suitable, B-Suitable, C-Limited application, D-No suitable

脱硫蝶阀

Desulfurization butterfly valve

简介 Brief

脱硫专用蝶阀是我公司根据目前国内烟气脱硫系统而设计的产品。为适应石灰石浆液和石膏浆液的腐蚀, 阀板和阀杆采用了特殊的耐腐蚀合金, 阀座采用高耐磨的橡胶, 适应液体中大量悬浮颗粒物对阀座的冲蚀。因此产品具有高耐磨性和高防腐性。由于产品是针对用户要求而设计, 所以具有针对性和高可靠性。

适用介质为石膏灰、二氧化硫、石灰膏浆液、工艺水等腐蚀性介质。

Desulfurization butterfly valve for my company is based on the current domestic flue gas desulphurization system and the design of products. To meet the limestone and gypsum slurry slurry of corrosion, disc and stem the use of a special corrosion-resistant alloys, valve seats using high wear-resistant rubber, to a large number of liquid particles in the erosion of the valve seat. Therefore products with high anti-corrosion and abrasion resistance and high. As products are designed for user requirements, targeted and high reliability.

Medium to apply gypsum ash, sulfur dioxide, lime slurry paste, process water, and other aggressive media.

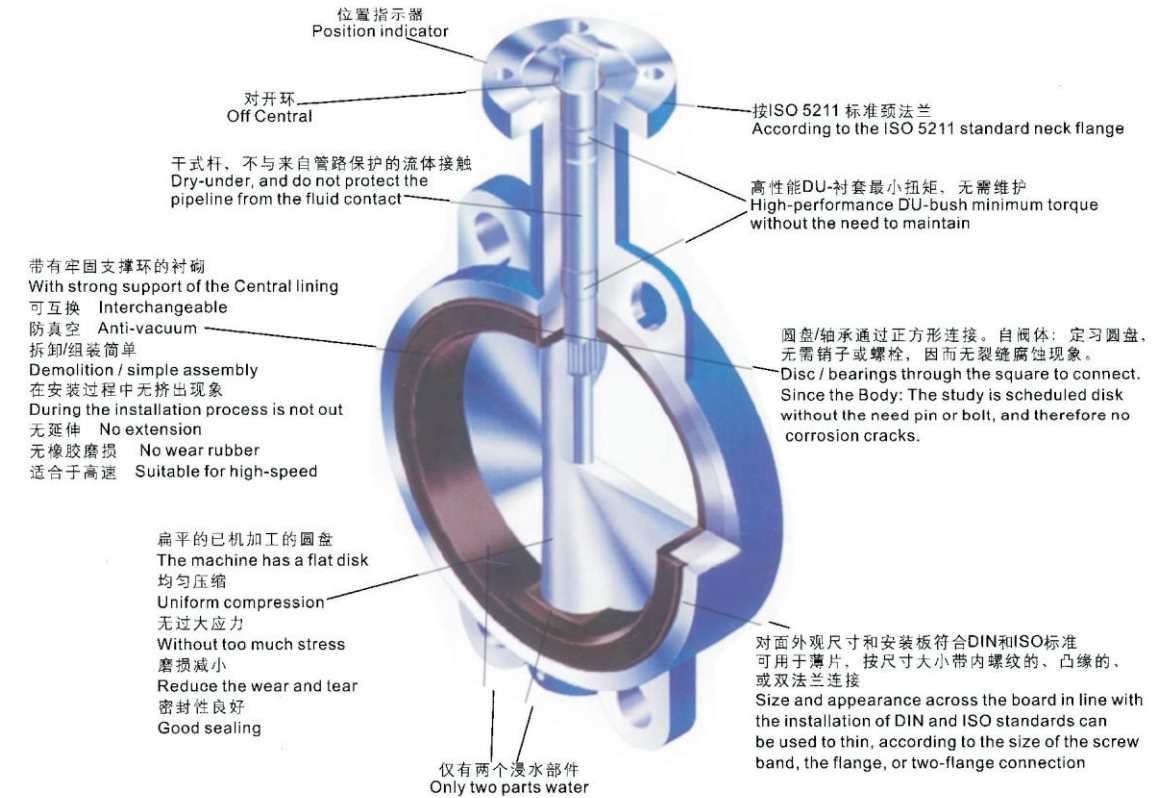

主要零部件材料 Material of main parts

阀体 Body		阀板 Disc		转轴 Stem	衬套 Bushing	阀座 Seat		
材料名称 Name	代号 Code	材料名称 Name	代号 Code	材料名称 Name	材料名称 Name	材料名称 Name	代号 Code	适用温度°C Working Temp
灰铸铁 Cast Iron	Z	电镀球墨铸铁 Plated Ductile Iron	B1	不锈钢 Stainless Steel	润滑青铜 Lubricated Bronze	天然胶 NR	X1	-20~+85
球墨铸铁 Ductile Iron	Q	铝青铜 Aluminum Bronze	T			海帕伦 Hypalon	X2	-18~+135 短时 -18~+149
铝青铜 Aluminum Bronze	T	ZG1Cr18Ni9Ti 不锈钢 Stainless Steel	P			乙丙橡胶 EPDM	X3	-45~+135 短时 -50~+150
ZG1Cr13Ni9Ti 不锈钢 Stainless Steel	P	钛钢 Titanium Steel	W	碳钢 Carbon Steel	聚四氟乙烯 PTFE	氯丁橡胶 Neoprene	X4	-7~+93 短时 -7~+107
CF8M不锈钢 Stainless Steel	R	CF8M不锈钢 Stainless Steel	R			丁腈橡胶 NBR	X5	-12~+82 短时 -12~+93
碳钢 Carbon Steel	C	碳钢 Carbon Steel	C			耐磨橡胶 Wear-resistant Rubber	X6	-10~+50
		CF8M不锈钢 Stainless Steel	M			氟橡胶 VITON	X7	-23~+150
		双相钢 Dual-phase steel	B5			耐热乙丙橡胶 Heat-resistant Rubber	X9	-20~+150
						聚四氟乙烯 PTFE	F4	+10~+150

对夹式蝶阀

Wafer butterfly valve

特点 Features

- 1、小型轻便，容易拆装及维修，并可在任意位置安装。
 - 2、结构简单，紧凑，90°回转启闭迅速。
 - 3、操作扭矩小，省力轻巧。
 - 4、流量特性趋于直线，调节性能好。
 - 5、启闭试验次数多达数万次，寿命长。
 - 6、达到完全密封，气体试验泄漏为零。
 - 7、选择不同零部件材质，可适用多种介质。
1. Small in size and light in weight. Easy installation and maintenance. It can be mounted wherever needed.
 2. Simple and compact construction, quick 90 degrees on-off operation.
 3. Minimized operating torque, energy saving.
 4. Flow curve tending to straight line. Excellent regulation performance.
 5. Long service life. Standing the test of thousands opening/closing operations.
 6. Bubble-tight sealing with no leakage under the pressure test.
 7. Wide selection of materials, applicable for various medium.

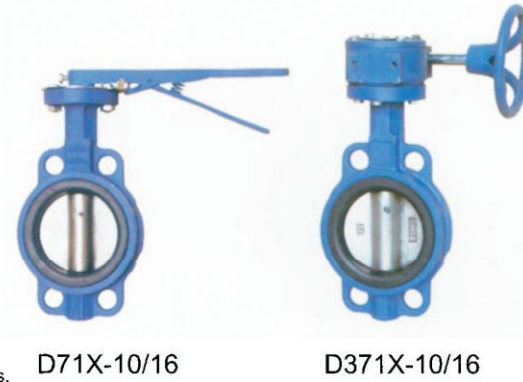

性能规范 Technical data

公称通径 DN(mm) Nominal diameter	50 (2") ~1000 (40")	50 (2") ~800 (32")
公称压力 PN(MPa) Nominal pressure	1.0	1.6
试验压力 Testing pressure	壳体 Shell	2.4
	密封 Sealing	1.76
适用温度 °C Working temperature	-15~+150	
适用介质 Suitable mediums	淡水、污水、海水、空气、蒸气、食品、药品、各种油类、酸类、碱类、盐类等 Fresh water, sewage, sea water, air, steam, food, medicine, oils, acids, etc.	

主要零部件材料 Material of main parts

阀体 Body		阀板 Disc		转轴 Stem	衬套 Bushing	阀座 Seat		
材料名称 Name	代号 Code	材料名称 Name	代号 Code	材料名称 Name	材料名称 Name	材料名称 Name	代号 Code	适用温度 °C Working temp
灰铸铁 Cast iron	Z	电镀球墨铸铁 Plated ductile iron	B1	不锈钢 Stainless steel	润滑青铜 Lubricated bronze	天然胶 NR	X1	-20~+85°C
球墨铸铁 Ductile iron	Q	铝青铜 Aluminum bronze	B2			海帕伦 Hypalon	X2	-23~+121°C
铝青铜 Aluminum bronze	T	ZG1Cr18Ni9Ti 不锈钢 Stainless steel	B3			乙丙橡胶 EPDM	X3	-23~+121°C
ZG1Cr13Ni9Ti 不锈钢 Stainless steel	P	钛钢 Titanium steel	B4			氯丁橡胶 Neoprene	X4	-7~+93°C
CF8M 不锈钢 Stainless steel	R	CF8M 不锈钢 Stainless steel	B5			丁腈橡胶 NBR	X5	-23~+100°C
碳钢 Carbon steel	C	碳钢 Carbon steel	B6			耐磨橡胶 Wear-resistant rubber	X6	-10~+100°C
		CF8M 不锈钢 Stainless steel	B7			氟橡胶 VITON	X7	-23~+200°C
				耐热乙丙橡胶 Heat-resistant rubber	X9	-23~+135°C		
				聚四氟乙烯 PTFE	F4	+10~+150°C		

对夹式蝶阀

Wafer butterfly valve

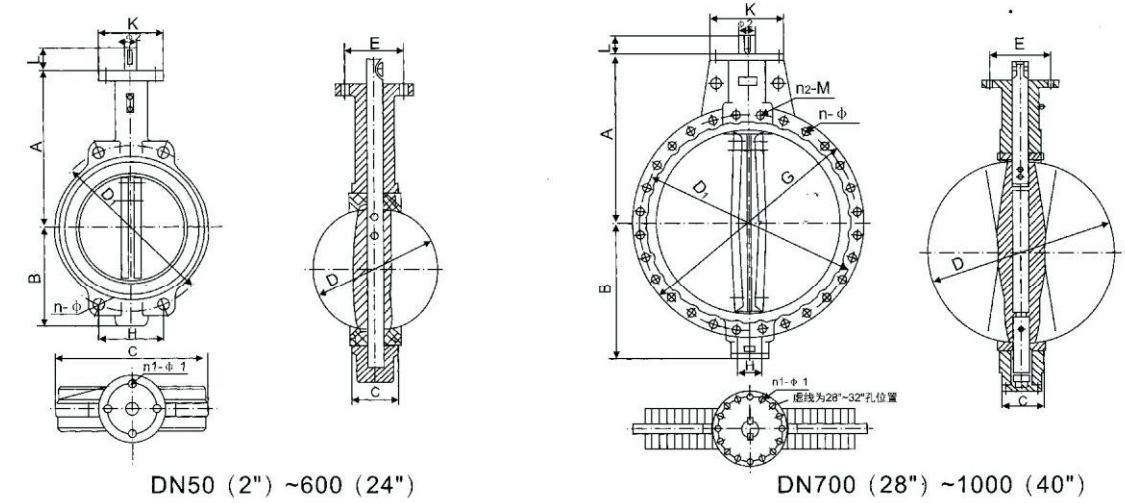

DN50 (2") ~600 (24")

DN700 (28") ~1000 (40")

"A"型蝶阀主要尺寸表和重量 Main dimensions and weight of type "A" butterfly valve

DN		A	B	C	D	L	H	D1	n-φ	K	E	n1-φ1	φ2	G	n2-M	重量 Weight (kg)
mm	inch															
50	2"	161	80	42	52.9	32	84.84	120	4-φ23	77	57.15	4-φ6.7	12.6	118	-	2.5
65	2.5"	175	89	44.7	64.5	32	96.2	136.2	4-φ26.5	77	57.15	4-φ6.7	12.6	137	-	3.2
80	3"	181	95	45.2	78.8	32	61.23	160	8-φ18	77	57.15	4-φ6.7	12.6	143	-	3.6
100	4"	200	114	52.1	104	32	70.80	185	4-φ24.5	92	69.85	4-φ10.3	15.77	156	-	4.9
125	5"	213	127	54.4	123.3	32	82.28	215	4-φ23	92	69.85	4-φ10.3	18.92	190	-	7
150	6"	226	139	55.8	155.6	32	91.08	238	4-φ25	92	69.85	4-φ10.3	18.92	212	-	7.8
200	8"	260	175	60.6	202.5	45	112.89 76.35	295	4-φ25 4-φ23	115	88.9	4-φ14.3	22.1	268	-	13.2
250	10"	292	203	65.6	250.5	45	92.40	357	4-φ29	115	88.9	4-φ14.3	28.45	325	-	19.2
300	12"	337	242	76.9	301.6	45	105.34	407	4-φ29	140	107.95	4-φ14.3	31.6	403	-	32.5
350	14"	368	267	76.5	333.3	45	91.11	467	4-φ30	140	107.95	4-φ14.3	31.6	436	-	41.3
400	16"	400	309	86.5	389.6	51.2 72	100.47 102.42	515	4-φ26 4-φ30	197	158.75	4-φ20.6	33.15	488	-	61
450	18"	422	328	105.6	440.51	51.2 72	88.39 91.51	565	4-φ26 4-φ30	197	158.75	4-φ20.6	38	539	-	79
500	20"	480	361	131.8	491.6	64.2 82	96.99 101.68	620 650	4-φ26 4-φ33	197	158.75	4-φ20.6	41.15	593	-	128
600	24"	562	459	152	592.5	70.2 82	113.42 120.46	725 770	20-φ30 20-φ36	276	215.9	4-φ22.2	50.65	816	-	188
700	28"	624	520	163	695	66 82	109.65	840	24-φ30 20-φ36	300	254	8-φ18	55 63.35	895	4-M33	284
800	32"	672	591	188	794.7	66 82	124	950	24-φ33 24-φ39	300	254	8-φ18	55 63.35	1015	-	368
900	36"	720	656	203	864.7	118	117.57	1050	24-φ33	300	254	8-φ18	75	1115	4-M30	713
1000	40"	800	721	216	965	142	129.89	1160	24-φ36	300	254	8-φ18	85	1230	4-M33	864

注Note:

DN50 (2")~800 (32") "A"型蝶阀分别适用于PN1.0/PN1.6MPa二种压力级，表中每格有两个尺寸的分别表示PN1.0/PN1.6MPa二种压力级连接尺寸。与阀门连接的管法兰连接尺寸参照法兰连接尺寸表。蝶阀上法兰可适用于手动、蜗轮蜗杆传动、电动、气动等。

表中DN50 (2")~500 (20")中D1和n-φ尺寸为蝶阀本身安装定位尺寸，其中DN50(2")~350(14")的D1和n-φ尺寸包含GB9112-88, DIN 2501(德国), BS4504(英国), ISO2084, ISO2531(国际标准), BS10-E(英国), ANSI1259(美国)等法兰连接标准。DN400 (16")~500(20")包含GB9112-88, DIN2501, ISO2084, BS4504法兰连接标准。

DN50 (2")~800 (32") Type "A" butterfly valves are suitable for the pressure of PN1.0MPa and PN1.6MPa grade separately. Two dimensions in one column show the connection dimensions of PN1.0/PN1.6MPa pressure grade. For the connection dimensions of pipe flanges mounted to the valves, please refer to the Connection Dimensions of Flanges Table. The upper flanges of the valves are suitable all types of valves fitted with electric, wormgear, manual, pneumatic and actuators.

The dimensions D1 and n-φ of DN50 (2")~500 (20") listed in above table show the installation dimensions of butterfly valve. Of them the dimensions D1 and n-φ of DN50 (2")~350 (14") contain the standard of GB9112-88, DIN2501 (Germany), BS4504(UK) ISO2084, ISO2531 (International standard) BS 10-E (UK) ANSI125 (USA) for flange connection and DN400 (16")~500 (20") contain the standard of GB9112-88, DIN2501, ISO2084 and BS4504.

对夹式蝶阀

Wafer butterfly valve



LTD71X-10/16

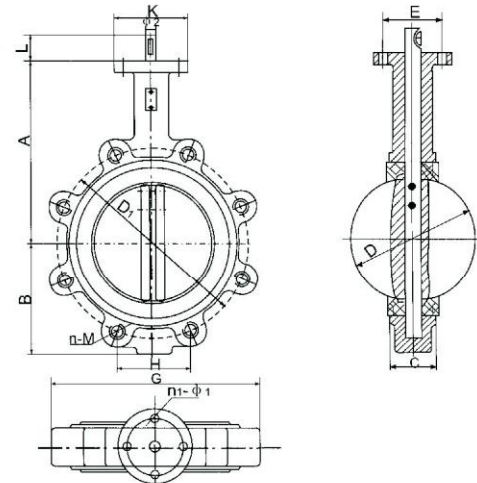

DN50 (2") ~600 (24")

"LT"型蝶阀主要尺寸表和重量 Main dimensions and weight of type "LT" butterfly valve

DN		A	B	C	D	L	H	D1	n-φ	K	E	n1-φ1	φ2	G	重量 Weight (kg)
mm	inch														
50	2"	161	80	42	52.9	32	88.38	125	4-M16	77	57.15	4-6.7	12.6	118	3.8
65	2.5"	175	89	44.7	64.5	32	102.54	145	4-M16	77	57.15	4-6.7	12.6	137	4.2
80	3"	181	95	45.2	78.8	32	61.23	160	8-M16	77	57.15	4-6.7	12.6	178	4.7
100	4"	200	114	52.1	104	32	68.88	180	8-M16	92	69.85	4-10.3	15.77	206	9.0
125	5"	213	127	54.4	123.3	32	80.36	210	8-M16	92	69.85	4-10.3	18.92	238	10.9
150	6"	226	139	55.8	155.6	32	91.84	240	8-M20	92	69.85	4-10.3	18.92	266	14.2
200	8"	260	175	60.6	202.5	45	112.89 76.35	295	8-M20 12-M24	115	88.9	4-14.3	22.1	329	18.2
250	10"	292	203	65.6	250.5	45	90.59 91.88	350 355	12-M20 12-M24	115	88.9	4-14.3	28.45	393	26.8
300	12"	337	242	76.9	301.6	45	103.52 106.12	400 410	12-M20 12-M24	140	107.95	4-14.3	31.6	462	40
350	14"	368	267	76.5	333.3	45	89.74 91.69	460 470	16-M20 16-M24	140	107.95	4-14.3	31.6	515	56
400	16"	400	309	86.5	389.6	51.2 72	100.48 102.42	515 525	16-M24 16-M27	197	158.75	4-20.6	33.15	579	96
450	18"	422	328	105.6	440.51	51.2 72	88.38 91.51	565 585	20-M24 20-M27	197	158.75	4-20.6	38	627	122
500	20"	480	361	131.8	491.6	64.2 82	96.99 101.68	620 650	20-M24 20-M30	197	156.25	4-20.6	41.15	696	202
600	24"	562	459	152	592.5	70.2 82	113.42 120.46	725 770	20-M27 20-M33	276	215.9	4-22.2	50.65	821	270

注Note:

DN50 (2") ~600 (24") "LT" 型蝶阀分别适用于 PN1.0/PN1.6MPa 二种压力级, 表中每格有两个尺寸的分别表示 PN1.0/PN1.6MPa 二种压力级连接尺寸。与阀门连接的管法兰连接尺寸参照法兰连接尺寸表。蝶阀上法兰可通用于手动、蜗轮蜗杆传动、电动、气动等传动装置。

"LT" 型蝶阀的结构、性能、零件的材质与 "A" 型均相同, 区别在于 "A" 型可通过双头螺栓 (或加长六角螺栓) 对夹连接在两管法兰之间 (即对夹式)。"LT" 型除通过两普通六角螺栓连接在两管路之间外, 还可以安装在管端 (即单夹式) 作为排空阀使用, 但需在订货合同中注明管端使用。

DN50(2")~600(24")Type"LT" butterfly valve are suitable for the pressure grades of PN1.0MPa and PN1.6MPa separately. Two dimensions in one column how two connection dimensions of PN1.0/PN1.6MPa pressure grade. For the connection dimensions of pipe flanges mounted to the valve. Please refer to the Connection Dimensions of flanges Table. The upper flanges of the butterfly valves accommodates all types of operators: manual, wormgear, electric and pneumatic actuators.

Difference between Type "A" and "LT": Both Type "A" and "LT" have the same construction and performances and are made of the same materials. The main difference between them is, that type "A" valves are mounted between pipe flanges (wafer type) by bolts (or extended hexagon-head bolts), while type "LT" can be either mounted between two pipes by ordinary hexagon head bolts or mounted on the pipe end (lugged-type). As the valve is used at the end of pipe line, it is necessary to indicate in order.

● 以上两种形式由用户在订货合同中注明。

Above two kinds of versions are given clear indication of by user in the order contract.

● 法兰连接尺寸符合G4216, DIN2501, BS4504, BS10-E, JISB2220, AS2129, ANSI B16.1等标准, 须用户在合同中注明。

The flange links the size and fits the standards such as GB4216, DIN2501, BS4504, BS10-E, JISB2220, AS2129, ANSI B16.1 etc, and must give clear indication of in the contract user.

无销蝶阀

Slim-disc butterfly valve

简介 Brief

无销蝶阀是我公司在对夹式蝶阀的基础上, 引进国外先进的设计制造技术, 开发的新产品。该产品具备了对夹式蝶阀的一切优点, 而且还具有抗腐蚀性强, 无销孔的优点。该产品主要适用于石油、化工、食品、医药、造纸、船舶、城市给排水、冶炼、能源等系统中作为调节和截流装置使用, 它可以在管线中任意位置安装。

Slim-disc butterfly valve is developed based on the wafer butterfly valve and advanced technology introduced from foreign country. In addition to the feature of the wafer butterfly valve. It has strong corrosion resistance and no-pin. This product is suitable for throttling-off and adjusting flow, and can be installed in pipelines in the industries of petroleum processing, chemicals, food medicine, textile, paper making, hydroelectricity engineering, ship building, water supply and sewage, metallurgy, energy engineering as well as light industry, etc.

性能规范 Technical data

公称口径 DN	Nominal diameter	50 (2") ~3000 (12")	
公称压力 PN	Nominal pressure	1.0	1.6
试验压力 Testing pressure	壳体 Shell	1.1	1.76
	密封 Sealing	1.5	2.4
适用温度 °C	Working temperature	-15~+100	
适用介质	Suitable mediums	淡水、污水、海水、空气、蒸气、食品、药品、各种油类、酸类、碱类、盐类等 Fresh water, sewage, sea water, air, steam, food, medicine, oils, acids, etc.	



WD71X-10/16

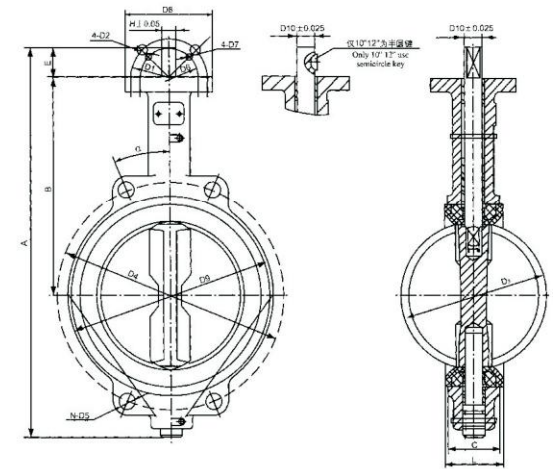

主要尺寸表 Main dimensions

DN		A	B	C	E	L	H	α	D1	D2	D3	D4	N-D5	D6	D7	D8	D9	D10
mm	inch																	
50	2"	280	161	42.04	32	45	9.52	45°	83	11	52.6	120	4-23	70	10	102	100	12.6
65	2 1/2"	303	175	44.68	32	47.6	9.52	45°	83	11	64.3	136.13	4-26.6	70	10	102	120	12.6
80	3"	315	181	45.21	32	49	9.52	45° 22.5°	83	11	78.8	152.4 160.0	4-24 4-18	70	10	102	127	12.6
100	4"	353	200	52.07	32	54.7	11.11	45° 22.5°	83	11	104	177.8 185.16	4-17.5 4-25.8	70	10	102	156	15.77
125	5"	379	213	54.36	32	58	12.7	22.5°	83	11	123.3	215.01	4-23	70	10	102	190	18.92
150	6"	404	226	55.75	32	58.6	12.7	22.5°	83	11	155.7	238.12	4-25	70	10	102	212	18.92
200	8"	487	260	60.58	45	63.4	15.87	15° 22.5°	127	14	202.4	296.07	4-23 4-26	102	12	152	268	22.1
250	10"	547	292	65.63	51	70	-	22.5° 15°	127	14	250.4	357	4-22 4-29	102	12	152	325	28.45
300	12"	631	337	76.9	51	70	-	15°	127	14	301.5	406.4 431.8	4-30.2 4-25.4	102	12	152	403	28.45

注Note:

"A"型侧法兰连接标准符合GB4216.4-GB4216.5-84, ANSI B16.1 125PSI, BS10D, BS10E, DIN2501 PN10, PN16, AS2129表E标准。

Type "A" side-flange connection is in compliance with the standard standard given in the GB4216.4-GB4216.5-84, ANSI B16.1 125PSI, BS10D, BS10E, DIN2501 PN10, PN16, table E of AS2129.

无销环氧覆层对夹式蝶阀 Manual wafer butterfly valve

特点 Features

- 1、小型轻便，容易拆装及维修，并可在任意位置安装。
- 2、结构简单，紧凑，90°回转变迅速。
- 3、操作扭矩小，省力轻巧。
- 4、流量特性趋于直线，调节性能好。
- 5、启闭试验次数多达数万次，寿命长。
- 6、达到完全密封，气体试验泄漏为零。
- 7、选择不同零部件材质，可适用多种介质。
- 8、转轴与阀板采用无销连接，性能更加可靠。
- 9、阀板衬胶、金属不接触介质，防腐性好。
- 10、适用介质：淡水、海水、各种气体、油品、耐酸、碱、盐等有机化学物。

1. Small in size and light in weight. Easy installation and maintenance. It can be mounted wherever needed.
2. Simple and compact construction, quick 90° degrees on-off operation.
3. Minimized operating torque, energy saving.
4. Flow curve tending to straight line. Excellent regulation performance.
5. Long service life. Standing the test of tens of thousands opening, closing operations.
6. Bubbles-tight sealing with no leakage under the pressure test.
7. Wide selection of materials, applicable for various medium.
8. Axle and valve's broad is linked by no line gum, function is more reliable.
9. Valve's broad line gum, steel aren't contact with medium, against corrosiveness is good.
10. Suitable mediums: water, sea water, different kinds of gasses, oil product, acidproof, alkali, salt grade organic chemistry thing.



WD71X-10/16

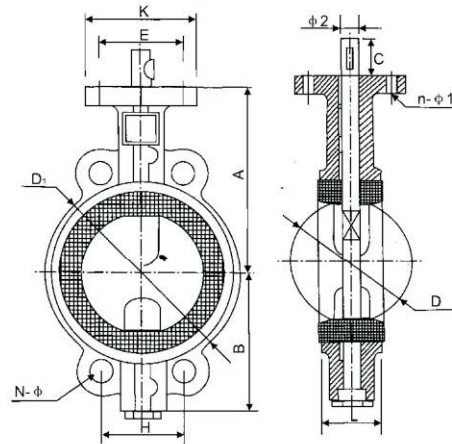

主要尺寸表和重量 Main dimensions and weight

DN		A	B	L	D	C	H	D1	N-φ	K	E	n-φ1	φ2	重量 Weight (kg)
mm	inch													
40	1.5"	130	73	41	52.7	28	77.78	110	4-φ18	77	57	4-φ7	12.7	3.8
50	2"	130	73	41	52.7	28	88.38	125	4-φ18	77	57	4-φ7	12.7	3.8
65	2.5"	142	80	43	64.4	28	120.13 113.13	145	4-φ18	77	57	4-φ7	12.7	4.2
80	3"	155	96	44.5	78.8	28	61.23	160	4-φ18	77	57	4-φ7	12.7	4.7
100	4"	170	123	50	104.2	28	68.88	180	8-φ18	92	69	4-φ10.5	15.8	9.0
125	5"	173	125	54	123.3	29	80.36	210	8-φ18	92	69	4-φ10.5	19.05	10.9
150	6"	204	140	54	157	29	91.84 112.89	240	8-φ18	92	69	4-φ10.5	19.05	14.2
200	8"	239	173	60	202.5	32	76.35	295	8-φ22 8-φ23	114	89	4-φ14.3	22.22	18.2
250	10"	275	200	66	250.5	40	90.59 91.88	350 355	12-φ23	115	89	4-φ14.3	28.6	26.8
300	12"	320	230	75.5	301.6	40	103.52 106.12	400 410	12-φ23 12-φ26	140	108	4-φ14.3	31.8	40
350	14"	368	267	76.5	333.3	40	89.74 91.69	460 470	12-φ23 12-φ26	140	108	4-φ14.3	31.8	56
400	16"	400	309	86.5	389.6	51.2 72	100.48 102.42	515 525	16-φ23 16-φ26	197	159	4-φ20.5	33.3	96
450	18"	422	328	105.6	440.51	51.2 72	88.38 91.51	565 585	16-φ26 16-φ30	197	159	4-φ20.5	38	122
500	20"	480	361	131.8	491.6	64.2 82	96.99 101.68	620 650	20-φ26 20-φ33	197	159	4-φ20.5	41.5	202
600	24"	562	459	152	592.5	70.2 82	113.42 120.46	725 770	20-φ30 20-φ36	276	215.9	4-φ22.2	50.65	270

注 Notes:

DN40~DN600mm全衬胶无销对夹蝶阀，分别适用于PN1.0~1.6MPa二种压力等级。可根据用户需求选用手动、蜗轮传动、电动、气动等连接尺寸。

DN40~DN600mm not line gum wafer butterfly valve, separately adopt to PN1.0~1.6MPa two pressure grade. Can be chosed handwork worm gear transmission, motor-driven, pneumatic line measurement and so on.

无销四氟覆层对夹式蝶阀 Entire four fluorine wafer butterfly valve

特点 Features

- 1、小型轻便，容易拆装及维修，并可在任意位置安装。
- 2、结构简单，紧凑，90°回转变迅速。
- 3、操作扭矩小，省力轻巧。
- 4、优异的减磨、自润滑性、操作力矩比普通蝶阀降低40%以上。
- 5、耐磨好(尼龙耐磨是铜的7倍)，可延长使用寿命。
- 6、无毒、无味、抗菌符合绿色环保要求。
- 7、耐盐、碱、弱酸侵蚀，适应性广。
- 8、无销连接技术，保证介质与金属完全隔离可靠性高。
- 9、产品价格远低于不锈钢阀门，明显降低工程造价。
- 10、适用介质：淡水、海水、各种气体、油品、碱、盐、有机化合物及弱酸等。

1. Small in size and light in weight. Easy installation and maintenance. It can be mounted wherever needed.
2. Simple and compact construction, quick 90 degrees on-off operation.
3. Minimized operating torque, energy saving.
4. The excellent antifricition, lubricate oneself, doing moment of force is the ordinary butterfly valve lower 40%.
5. Wear-resisting is good, (nylon wear-resisting is 7 times of copper) can lengthen one's life.
6. Innocuity, no flavour, against fungus according with the require of green environmental.
7. Salt-resisting, soda-resisting, weakacid-resisting, it's adaptability is wide.
8. The technology of no line gum linking ensure the reliable what medium keep apart metal.
9. The product's price is most poor than stainless steel, clear reduce the cost of engineering.
10. Be suitable of medium: fresh water, sea water, all kinds of gas, oil, soda, salt, organism and weak acid.



WD71F-10/16

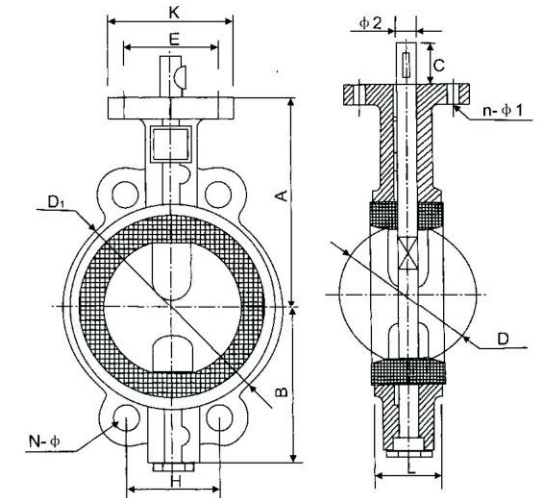

主要尺寸表和重量 Main dimensions and weight

DN		A	B	L	D	C	H	D1	N-φ	K	E	n-φ1	φ2	重量 Weight (kg)
mm	inch													
40	1.5"	130	73	41	52.7	28	77.8	110	4-φ18	77	57	4-φ7	12.7	3.8
50	2"	130	73	41	52.7	28	88.38	125	4-φ18	77	57	4-φ7	12.7	3.8
65	2.5"	142	80	43	64.4	28	120.54 113.13	145	4-φ18	77	57	4-φ7	12.7	4.2
80	3"	155	96	44.5	78.8	28	61.23	160	4-φ18	77	57	4-φ7	12.7	4.7
100	4"	170	123	50	104.2	28	68.88	180	8-φ18	92	69	4-φ10.5	15.8	9.0
125	5"	173	125	54	123.3	29	80.36	210	8-φ18	92	69	4-φ10.5	19.05	10.9
150	6"	204	140	54	157	29	91.84 112.89	240	8-φ18	92	69.85	4-φ10.5	19.05	14.2
200	8"	239	173	60	202.5	32	76.35	295	8-φ22 8-φ23	114	89	4-φ14.3	22.22	18.2
250	10"	275	200	66	250.5	40	90.59 91.88	350 355	12-φ23	115	89	4-φ14.3	28.6	26.8
300	12"	320	230	75.5	301.6	40	103.52 106.12	400 410	12-φ23 12-φ26	140	108	4-φ14.3	31.8	40
350	14"	368	267	76.5	333.3	40	89.74 91.69	460 470	12-φ23 12-φ26	140	108	4-φ14.3	31.8	56
400	16"	400	309	86.5	389.6	51.2 72	100.48 102.42	515 525	16-φ23 16-φ26	197	159	4-φ20.5	33.3	96
450	18"	422	328	105.6	440.51	51.2 72	88.38 91.51	565 585	16-φ26 16-φ30	197	159	4-φ20.5	38	122
500	20"	480	361	131.8	491.6	64.2 82	96.99 101.68	620 650	20-φ26 20-φ33	197	159	4-φ20.5	41.5	202
600	24"	562	459	152	592.5	70.2 82	113.42 120.46	725 770	20-φ30 20-φ36	276	216	4-φ22.2	50.65	270

注 Notes:

DN40~DN600mm全衬四氟覆层无销蝶阀，分别适用于PN1.0~1.6MPa二种压力等级。可根据用户需求选用手动、蜗轮传动、电动、气动等连接尺寸。

DN40~DN600mm PTFE lining nylon overlying strata not line gum butterfly valve, separately adopt to PN1.0~1.6MPa two pressure grade. Can be chosed handwork worm gear transmission, motor-driven, pneumatic line measurement and so on.

全四氟对夹蝶阀

Worm four fluorine wafer butterfly valve

简介 Brief

本公司生产的聚四氟乙烯蝶阀(俗称:塑料王)由美国DUPONT COLTD 于1938年首先研制问世, 1949年进行工业化生产。50年的应用历史证明: 在抗腐蚀材料中聚四氟乙烯有不可比拟的优异性能。90年代初, 我公司根据国外产品的特点, 研制开发出的全衬聚四氟乙烯球面密封蝶阀。该产品质量优异、外观精美、质量可靠、领先水平、信誉良好、目前已销往全国, 被国内几十家大中型化工企业定点采用。

This factory the PTFE butterfly valve (custom is called: plastics kings) is published by the American the most before all others development of DUPONT COLTD in 1938, and carried on industrialize production in 1949. The application history of 50 years provs: the polytetrafluoroethylene has excellent function can not compare in resists corrodng the material. At beginning in the 90's that our factory developes otu according to the characteristic of product of abroad lines that the olytetrafluoroethylene sphere section sealing butterfly valve entirely. This product quality is excellent and the outward appearance is exquisite and the quality is reliable and leading standard and presige well, and melting toward the whole nation at present, internal tens the big and medium-sized chemical industry enterprises of quilt fix a point to adopt.

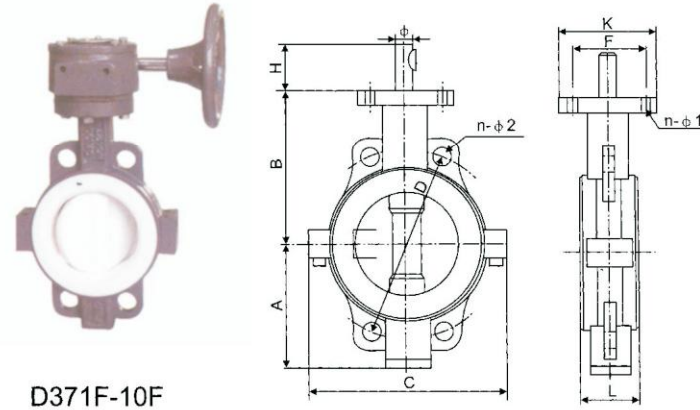

D371F-10F

主要零部件材料 Material of main parts

序号	零件名称 Part name	材料名称 Material name	序号	零件名称 Part name	材料名称 Material name
1	阀体 Valve body	灰铸铁、球铁、铸钢、不锈钢 Cast Iron, Ductile iron, cast steel and stainless steel	8	密封圈 Sealing-circle	氟橡胶、聚四氟乙烯 Fluorine rubber and PTFE
2	蝶板 Butterfly board	聚四氟乙烯 PTFE	9	档圈 Shelves circles	弹簧圈 Spring coil
3	阀座 Valve seat	聚四氟乙烯 PTFE	10	阀座靠背 Valve seat back	DN50~DN350 酚醛树脂 Phenolic resin DN400~DN800 铝合金 Aluminium alloy
4	阀轴 Valve axle	316不锈钢 316 stainless steel	11	自密封压套 White sealing pressure cover	氟橡胶、聚四氟乙烯 Fluorine rubber and PTFE
5	蝶板芯 Butterfly board stamen or pistil	铸钢、球铁、不锈钢 Cast steel and Ductile iron and stainless steel	12	隔套 Cover	聚四氟乙烯 PTFE
6	圆垫片 Gasket in garden	黄铜、不锈钢 Brass and stainless steel	13	止推轴承 Thrust bearing	DN350~DN600 润滑青铜 Lubricates bronze DN700~DN800 滚动轴承 Rolling bearing
7	衬套 Bush	润滑青铜、聚四氟乙烯 Bronze and PTFE	14	锥销 The awl forelock	不锈钢 Stainless steel

主要尺寸表和重量 Main dimensions and weight

DN		A	B	C	L	H	K	D1	n-φ1	E	φ	n-φ2	重量 Weight (kg)
mm	inch												
50	2"	77	135	130	42	32	77	120	4-φ6.7	57.15	12.7	4-φ22	3.2
65	2.5"	91	138	150	45	32	77	136.2	4-φ6.7	57.15	12.7	4-φ22	5.8
80	3"	95	138	164	45.2	32	77	160	4-φ6.7	57.15	12.7	4-φ22	6.5
100	4"	121	149	188	52	32	92	185	4-φ10.3	69.85	15.8	4-φ24	11
125	5"	125	173	220	54	32	92	215	4-φ10.3	69.85	19	4-φ24	13
150	6"	150	187	252	56	32	92	238	4-φ10.3	69.85	19	4-φ26	16
200	8"	182	225	305	61	45	115	295	4-φ14.5	88.9	22.2	4-φ26	27
250	10"	226	255	370	65.3	45	115	357	4-φ14.5	88.9	28.6	4-φ29	35
300	12"	260	295	430	77	45	140	407	4-φ14.5	107.95	31.8	4-φ29	51
350	14"	275	335	470	77	45	140	467	4-φ14.5	107.95	31.8	4-φ30	76
400	16"	305	410	565	86.5	51.2	197	515	4-φ20.6	158.75	33.34	4-φ28	97
450	18"	338	440	620	105.5	51.2	197	565	4-φ20.6	158.75	38	4-φ28	125
500	20"	375	495	695	131.8	64	197	620	4-φ20.6	158.75	41.15	4-φ28	186

防结露蝶阀

Against condensation butterfly valve

简介 Brief

我厂生产的防结露蝶阀采用了高性能顶盘材料, 能有效地防止阀体部分的温差, 隔离了管道内介质的传递, 达到了执行器和连接法兰表面无结露。高性能的材料有很多出色的优点: 如低吸水性、抗腐蚀性、绝热隔冷性能等, 是普通材质蝶阀的4倍。适用于暖通、中央空调上下水成套设备, 广泛应用于: 水、气、油、化工、冶炼、能源、造船、电力、石油、水处理、建筑等各行业。

I plant the production of anti-condensation butterfly valve high performance top plate material, and can effectively prevent the body part of the temperature difference, isolation medium inside the tubes pass to the actuator and connect the flange surface condensation. The high-performance materials has many outstanding advantages: such as low water absorption, corrosion resistance, thermal insulation at cold performance is 4 times the ordinary materials butterfly valve. For equipment in the HVAC, central air conditioning up and down the water, lack of widely used in various sectors: water, gas, oil, chemical industry, metallurgy, energy, shipbuilding, electric power, petroleum, water treatment, construction.

标准参数表 Standard parameter list

类型 Type	DF	结构长度 Structural length	JIS GB API
阀门公称通径 The valve nominal passes the diameter	40mm~300mm	顶部法兰标准 Crown flange standard	国家标准ISO 5211 GB code standard ISO 5211
适用法兰规格 Suitable flange specification	JIS ANSI GB	标准材质 Standard material quality	阀体: 铝合金 Valve body: Aluminum alloy
最大工作压力 Biggest working pressure	1.0MPa, 1.6MPa		阀板: 不锈钢 Valve board: Stainless steel
使用温度范围 Application temperature scope	-45~135°C EPDM -12~82°C NBR		密封圈: EPDM (NBR) Seal packing collar: EPDM (NBR)
泄漏试验压力 Divulges the test pressure	1.1MPa, 1.76MPa	喷涂规格 Sprurts spreads the specification	聚酯粉体涂料 Polyester powder body coating
阀体试验压力 Valve body test pressure	1.5MPa, 2.4MPa		
驱动形式 Actuation form	手柄式、齿轮式、气缸式、电动式 Handle type, tooth wheeled, air cylinder type, electromotive type		

优异持久的密封性能 Outstanding lasting sealing property

特有的多层次渐进接触式阀座设计, 使阀板在关闭过程中逐渐接触阀座, 在保证良好的密封性能的同时, 减少不必要的扭矩, 从而延长阀座的使用寿命。

Unique multi-level advances gradually the contact type valve seat design, causes the valve board gradually to contact the valve seat in the closure process, during guarantee good sealing property, reduces the nonessential torque, thus lengthens the valve seat the service life.

- 超轻铝合金阀体, 扭矩小;
The ultra light aluminum alloy valve body, the torque is small;
- 使用安装方便, 杜绝锈蚀;
The use installment is convenient, ceases the rust eclipse;
- 扭矩减小实现了驱动装置的轻量化和小型化;
The torque reduced realizes the drive weight to be light and the minaturization;
- 独有的阀杆密封环防止流体泄漏;
Is in sole possession of the valve lever packing ring prevented the fluid divulges;
- 不同材质的阀座, 适应不同工况, 具有良好的防腐和密封性能。
The different material quality valve seat, the adaption different operating mode, has the good anticorrosion harmoniously to seal the performance

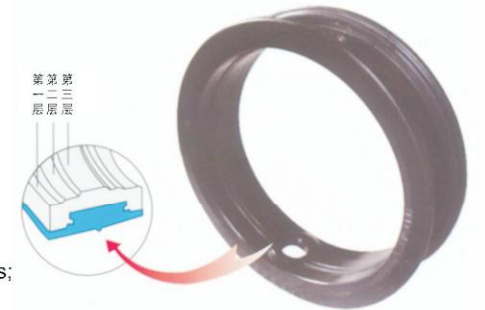

防结露蝶阀

Against condensation butterfly valve

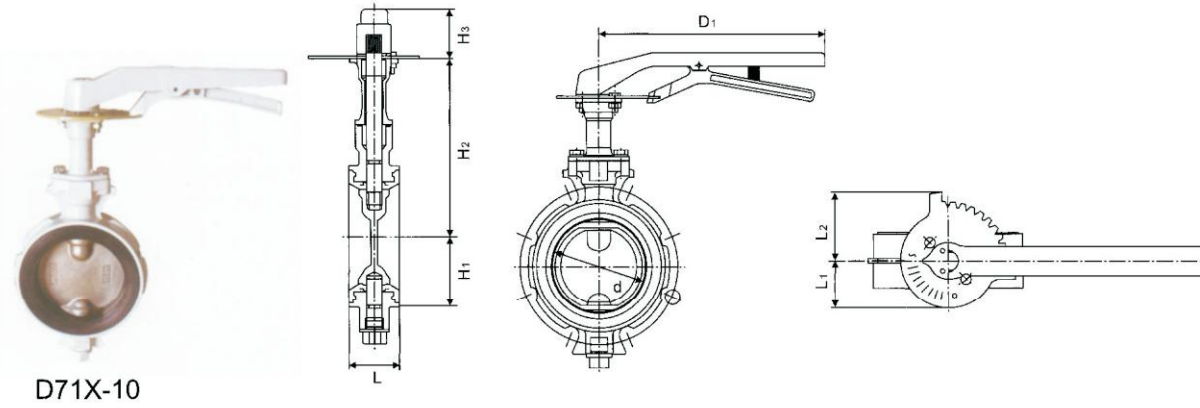

D71X-10

主要尺寸表和重量 Main dimensions and weight

DN		d	L	H ₁	H ₂	H ₃	L ₁	L ₂	D ₁	重量 Weight (kg)
mm	inch									
40	1 1/2"	42	33	70	145	51	47	68	250	1.4
50	2"	52	43	82	145					1.7
65	2 1/2"	67	46	90	157	60	63	86	330	2.1
80	3"	80	46	99	165					2.3
100	4"	102	52	112	183					2.8
125	5"	126	56	132	196	60	63	86	330	4.8
150	6"	150	56	146	214					6.0

D371X-10

主要尺寸表和重量 Main dimensions and weight

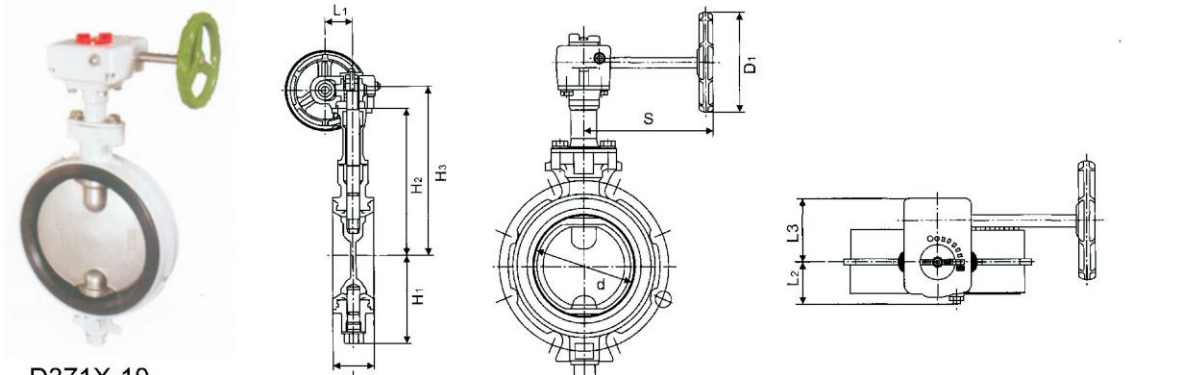

DN		d	L	H ₁	H ₂	H ₃	L ₁	L ₂	L ₃	S	D ₁	重量 Weight (kg)
mm	inch											
40	1 1/2"	42	33	70	145	168	35	35	56	132	100	2.0
50	2"	52	43	82	145	168						2.3
65	2 1/2"	67	46	90	157	180	41	39	68	149	140	2.7
80	3"	80	46	99	165	188						2.9
100	4"	102	52	112	183	206						3.4
125	5"	126	56	132	196	220	58	48	89	149	140	5.8
150	6"	150	56	146	214	238						7.4
200	8"	199	60	188	241	272	67	61	97	178	200	9.6
250	10"	248	68	220	320	367						21.5
300	12"	297	78	255	402	402	63	97	178	200	31.0	

蝶阀系列

BUTTERFLY VALVE SERIES

电动对夹脱硫蝶阀

Electric wafer desulfurization butterfly valve

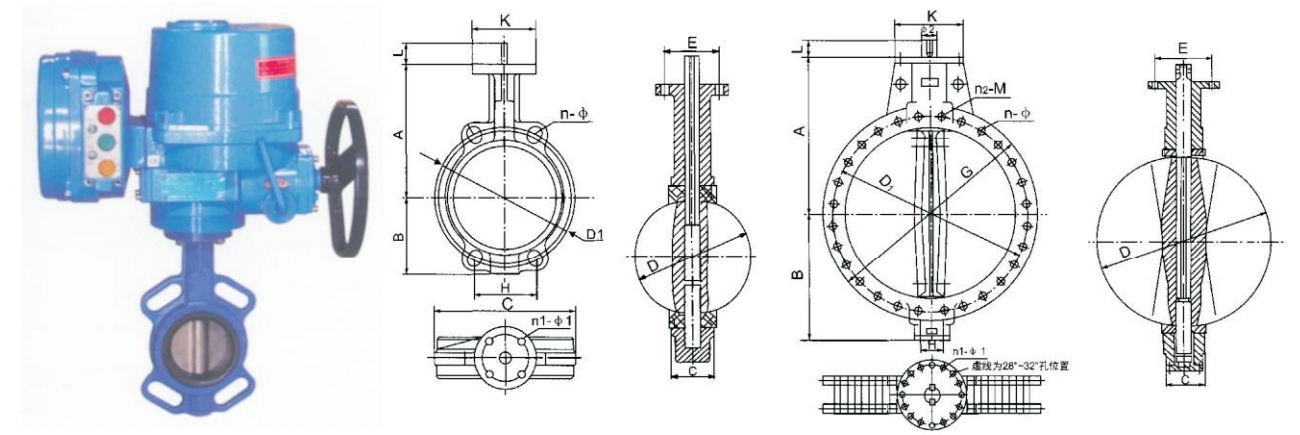

TLD971X-10/16

DN50 (2") ~600 (24")

DN700 (28") ~1000 (40")

主要尺寸表和重量 Main dimensions and weight

DN		A	B	C	D	L	H	D ₁	n-φ	K	E	n1-φ	圆轴 φ2	扁轴 φ2	方轴 φ2	G	n2-M	重量 (kg) Weight
mm	inch																	
50	2"	146	68	42	52.9	32	84.84	120	4-23	90	70	4-6.7	12.6	10	9×9	118	-	2.5
65	2.5"	152	75	44.7	64.5	32	96.2	136.2	4-26.5	90	70	4-6.7	12.6	10	9×9	137	-	3.2
80	3"	163	93	45.2	78.8	32	61.23	160	8-18	90	70	4-6.7	12.6	10	9×9	143	-	3.6
100	4"	173	104	52.1	104	32	70.80	185	4-24.5	90	70	4-10.3	15.77	12	11×11	156	-	4.9
125	5"	194	118	54.4	123.3	32	82.28	215	4-23	90	70	4-10.3	18.92	14	14×14	190	-	7
150	6"	206	133	55.8	155.6	32	91.08	238	4-25	90	70	4-10.3	18.92	14	14×14	212	-	7.8
200	8"	234	165	60.6	202.5	45	112.89 76.35	295	4-25 4-23	125	102	4-14.3	22.1	17	17×17	268	-	13.2
250	10"	271	197	65.6	250.5	45	92.40	357	4-29	125	102	4-14.3	28.45	22	22×22	325	-	19.2
300	12"	309	224	76.9	301.6	45	105.34	407	4-29	125	102	4-14.3	31.6	24	22×22	403	-	32.5
350	14"	368	267	76.5	333.3	45	91.11	467	4-30	125	102	4-14.3	31.6	24	22×22	436	-	41.3
400	16"	400	309	86.5	389.6	51.2 72	100.47 102.42	515 525	4-26 4-30	175	140	4-20.6	33.15			488	-	61
450	18"	422	328	105.6	440.51	51.2 72	88.39 91.51	565 585	4-26 4-30	175	140	4-20.6	38			539	-	79
500	20"	480	361	131.8	491.6	64.2 82	96.99 101.68	620 650	4-26 4-33	175	140	4-20.6	41.15			593	-	128
600	24"	562	459	152	592.5	70.2 82	113.42 120.46	725 770	20-30 20-36	210	165	4-22.2	50.65			816	-	188
700	28"	624	520	163	695	66 82	109.65	840	24-30 20-36	300	254	8-18	63.35			895	4-M33	284
800	32"	672	591	188	794.7	66 82	124	950	24-33 24-39	300	254	8-18	63.35			1015	-	368
900	36"	720	656	203	864.7	66 82	117.57	1050	24-33	300	254	8-18	75			1115	4-M30	713
1000	40"	800	721	216	965	66 82	129.89	1160	24-36	300	254	8-18	85			1230	4-M33	864

注Note:

DN50 (2") ~800 (32") "A" 型蝶阀分别适用于PN1.0/PN1.6MPa二种压力级, 表中每格有两个尺寸的分别表示PN1.0/PN1.6MPa二种压力级连接尺寸。与阀门连接的法兰连接尺寸参照法兰连接尺寸表(图一)。蝶阀上法兰可通用于手动、蜗轮蜗杆传动、电动、气动等。

表中DN50 (2") ~500 (20") 中D1和n-φ尺寸为蝶阀本身安装定位尺寸, 其中DN50(2")~350(14")的D1和 n-φ尺寸包容GB9112-88, DIN2501(德国), BS4504(英国), ISO2084, ISO2531(国际标准), BS10-E(英国), ANS11259(美国)等法兰连接标准。DN400(16")~500(20")包容GB9112-88, DIN2501, ISO2084, BS4504法兰连接标准。

The dimensions D1 and n-φ of DN50(2")~500(20") listed in above table show the installation dimensions of butterfly valve. Of them the dimensions D1 and n-φ of DN50(2")~350(14") contain the standard of GB9112-88, DIN2501(Germany), BS4504(UK) ISO2084, ISO2531(International standard) BS10-E (UK) ANS1125 (USA) for flange connection and DN400 (16")~500(20") contain the standard of GB9112-88, DIN2501, ISO2084 and Bs4504.

法兰蝶阀

Flanged butterfly valve

用途 Introduction

本公司生产的蜗轮传动法兰蝶阀，广泛应用于公称压力： \leq PN1.6MPa，适用温度： \leq 200℃的石油、化工、食品、医药、冶金、船舶、造纸、工业环保、给排水、高层建筑管道上，可在多种腐蚀性、非腐蚀性的气体、液体、浆流体及固体粉末管线和容器作启闭或调节介质流量之用。

The company's worm gear drive flange butterfly valve is widely used in the nominal pressure: \leq PN1.6MPa, application temperature: \leq 200°C oil, chemical, food, medicine, metallurgy, shipbuilding, paper, industrial environmental protection, water supply and drainage, high-rise building the pipeline, in a variety of corrosive, non-corrosive gases, liquids, liquid and solid powder loading pipelines and containers for hoisting or adjust the flow of the medium used.

性能规范 Technical data

公称通径 DN(mm) Nominal diameter	DN50~1000
公称压力 PN(MPa) Nominal pressure	1.0~1.6
适用温度 °C Working temperature	-23~+100
适用介质 Suitable mediums	淡水、污水、海水、气体等 Fresh water, sewage, sea water, gas etc.

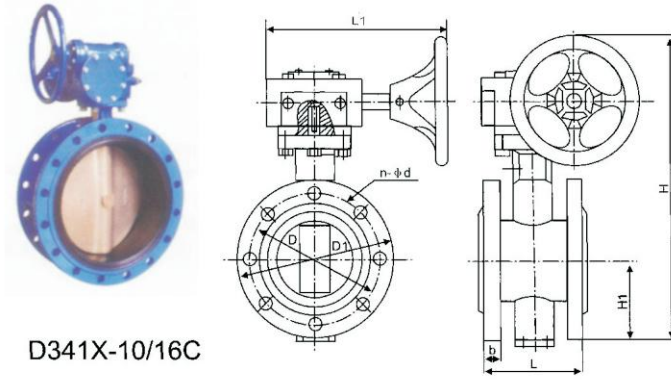

D341X-10/16C

主要零部件材质 Material of main parts

零件名称 Part name	材料名称 Material name
阀体 Valve body	灰铸铁、球墨铸铁、不锈钢 Cast iron, ductile iron, stainless steel
阀板 Valve disc	球墨铸铁、不锈钢、铝合金 Ductile iron, Stainless steel, aluminium alloy
阀轴 Valve stem	碳钢、不锈钢 Carbon steel, stainless steel
阀座 Valve seat	橡胶 Rubber
密封 Seal	O型圈 O Type ring

主要尺寸表

DN		L	L1	D		D1	H	H1	b	n-φd	
mm	inch			PN1.0MPa	PN1.6MPa					PN1.0MPa	PN1.6MPa
50	2"	108	180	125	125	150	326	83	20	4-φ18	4-φ18
65	2 1/2"	112	180	145	145	165	344	93	20	4-φ18	4-φ18
80	3"	114	180	160	160	200	363	100	22	4-φ18	8-φ18
100	4"	127	180	180	180	220	396	114	22	8-φ18	8-φ18
125	5"	140	180	210	210	250	421	125	24	8-φ18	8-φ18
150	6"	140	180	240	240	280	453	143	24	8-φ23	8-φ23
200	8"	152	270	295	295	335	578	170	26	8-φ23	12-φ23
250	10"	165	270	350	355	405	638	198	26	12-φ23	12-φ28
300	12"	178	380	400	410	455	731	223	32	12-φ23	12-φ28
350	14"	190	380	460	470	525	783	270	36	16-φ23	16-φ28
400	16"	216	450	515	525	580	888	300	38	16-φ28	16-φ31
450	18"	222	480	565	585	640	958	340	40	20-φ28	20-φ31
500	20"	229	480	620	650	705	1005	355	42	20-φ28	20-φ34
600	24"	267	480	725	770	825	1128	410	48	20-φ30	20-φ36
700	28"	292	640	840	840	920	1476	478	53	24-φ30	24-φ36
800	32"	318	640	950	950	1020	1533	525	58	24-φ33	24-φ39
900	36"	330	750	1050	1050	1120	1655	585	65	28-φ33	28-φ39
1000	40"	410	850	1160	1170	1340	1765	640	76	28-φ36	28-φ42
1200	48"	470	850	1380	1390	1560	1995	755	85	32-φ39	32-φ48
1400	56"	530	1000	1590	1590	1760	2310	910	103	36-φ42	36-φ48
1600	64"	600	1000	1820	1820	1970	2595	1030	123	40-φ48	40-φ56
1800	72"	697	1100	2020	2020	2180	2810	1140	135	44-φ48	44-φ56
2000	80"	760	1100	2230	2230	2345	3100	1250	145	48-φ48	48-φ62

软密封双偏心法兰蝶阀

Resilient seated double eccentric flanged butterfly valve

特点 Features

1. 结构简单紧凑、重量轻，90° 旋转，启闭灵活迅速。
2. 采用偏心结构，减少密封圈的摩擦，延长阀门使用寿命。
3. 密封结构设计合理，达到安全密封，泄漏为零，能适应较恶劣工况。
4. 更换阀板密封圈、O型圈、阀板、转轴等材质，可适用多种介质和不同温度。
5. 阀体具有地脚支撑，可实现阀门的立式或卧式安装。
6. 拆装容易，便于维修。

1. Simple and compact structure, light weight, 90° rotation, quick and flexible opening and closing.
2. Eccentric structure allows reduced friction with seal ring and extended service life.
3. Sound seal design gives a full sealing without any leakage, thus ensuring a reliable application in adverse working condition.
4. By changing disc seal ring, O ring, disc, shaft and the like, the product can be used in many different media and temperature conditions.
5. The valve body is provided with foundation support, so it can be installed either vertically or horizontally.
6. Easy to mount and dismantle thus convenient for servicing.

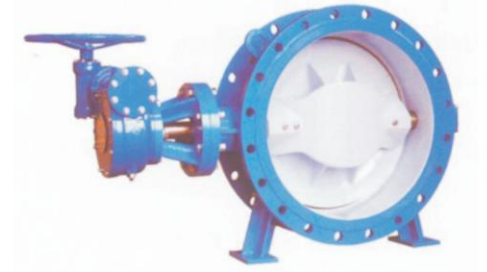

D343X-10

性能规范 Technical data

公称通径 Nominal diameter (DN)	100 ~ 2600	100 ~ 1200	600 ~ 3000
公称压力 Nominal pressure (PN)	1.0	1.6	0.6
试验压力 Testing pressure	壳体 Shell	1.5	2.4
	密封 Sealing	1.1	1.76
适用温度 °C Suitable temperature	-10 ~ 80		
适用介质 Suitable medium	淡水、污水、海水、空气 Portable water, sewage, sea water, air and etc.		

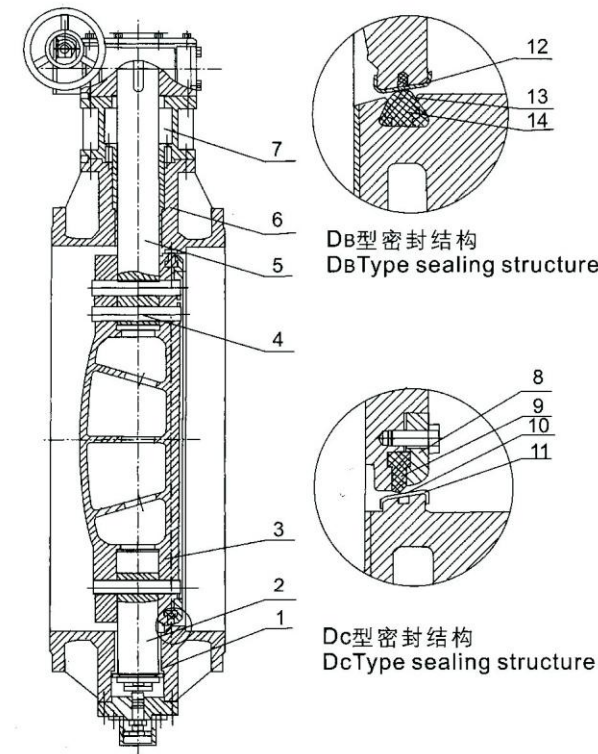

主要零部件材料 Material of main parts

序号 No.	部件 Part	材质 Material
1	轴套 Bushing	ZCuZn38Mn2Pb2, 钢背F4
2	下转轴 Bottom shaft	2Cr13
3	阀板 Disc	QT450-10
4	圆锥销 Taper pin	2Cr13
5	上转轴 Top shaft	2Cr13
6	阀体 Body	HT200, HT250, QT450-10
7	填料 Packing	丁腈橡胶NBR
8	压环 Retainer	QT450-10, Q235-A
9	阀板密封圈 Disc sealing ring	丁腈橡胶NBR
10	阀体钢环 Steel body ring	316SS
11	密封圈 Sealing ring	丁腈橡胶NBR
12	阀板钢环 Steel disc ring	OCr18Ni9
13	填充物 Stuffing	环氧树脂 Epoxy resin
14	阀体密封圈 Body sealing ring	丁腈橡胶NBR

软密封双偏心法兰蝶阀

Resilient seated double eccentric flanged butterfly valve

主要尺寸表和重量 Main dimensions and weight

D343X-10Q DN100~500mm

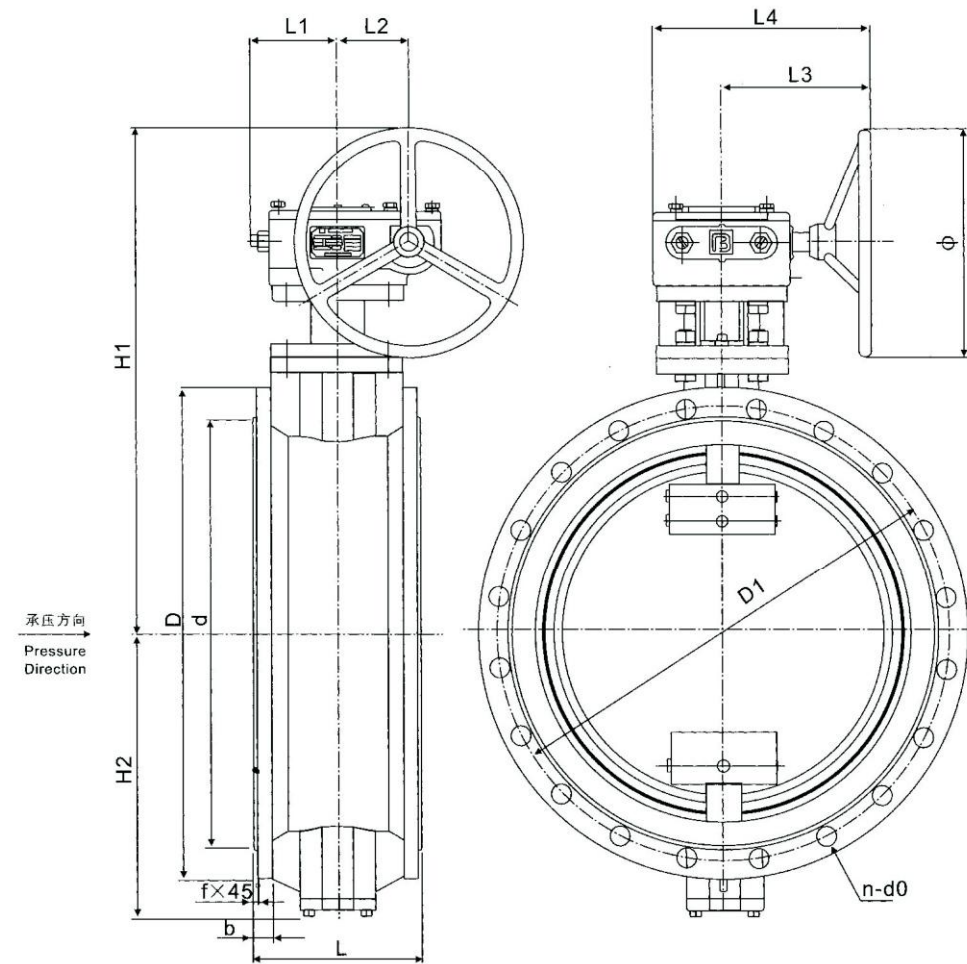

DN	传动装置 Gear operator	L	D	D1	d	n	d0	b	f	H1	H2	L1	L2	L3	L4	φ	重量 Weight (kg)
100	XJ24	127	220	180	156	8	19	19	3	310	109	52	45	158	210	150	19
150	XJ24	140	285	240	211	8	23	19	3	440	143	52	45	158	210	150	37
200	XJ30	152	340	295	266	8	23	20	3	510	182	77	63	238	315	300	51
250	XJ30	165	395	350	319	12	23	22	3	565	219	77	63	238	315	300	68
300	4022	178	445	400	370	12	23	24.5	4	630	244	95	72	167	242	300	93
350	4023	190	505	460	429	16	23	24.5	4	715	283	110	91	188	275	400	122
400	4023	216	565	515	480	16	28	24.5	4	750	312	110	91	188	275	400	152
450	4024	222	615	565	530	20	28	25.5	4	820	344	473	147	109	420	400	182
500	4024	229	670	620	582	20	28	26.5	4	845	381	473	147	109	420	400	230

软密封双偏心法兰蝶阀

Resilient seated double eccentric flanged butterfly valve

主要尺寸表和重量 Main dimensions and weight

D343X-10/6Q DN600~1200mm
D342X-10Q DN1400~2600mm

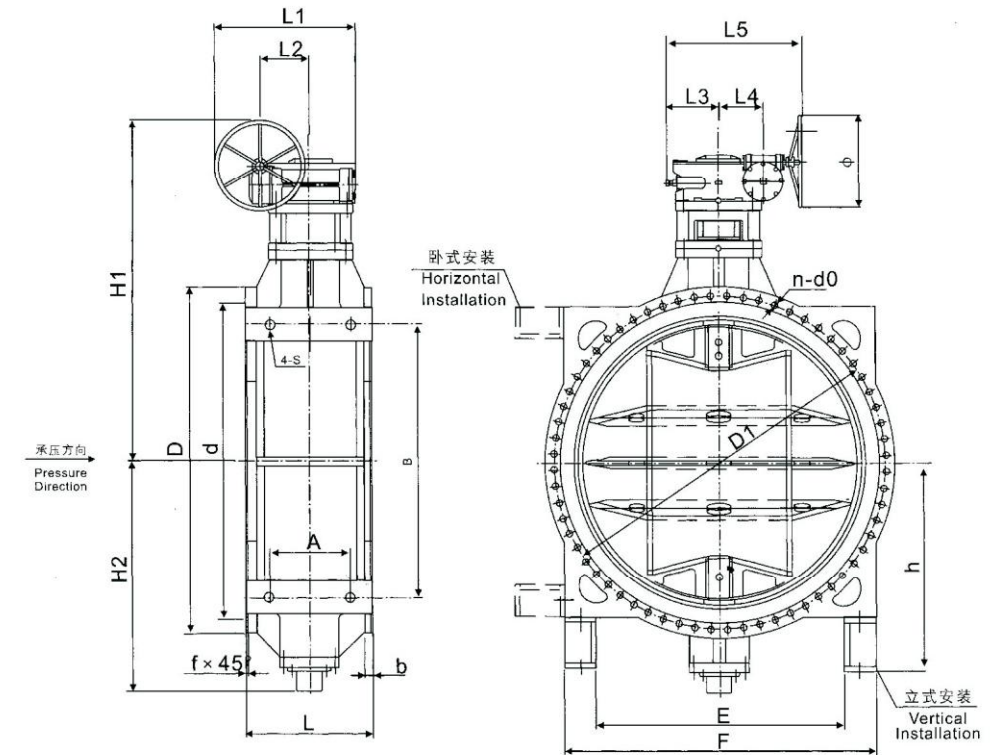

DN	传动装置 Gear operator	L	D	D1	d	n	d0	b	f	H1	H2	L1	L2	L3	L4	φ	重量 Weight (kg)
600	4025	267	780/755	725/705	682/667	20	31/26	30	5	950	451	533	179	138	476	400	388
700	4025	292	895/860	840/810	794/772	24	31/26	32.5	5	1010	526	533	179	138	476	400	480
800	4026	318	1015/975	950/920	901/878	24	34/31	35	5	1140	581	655	217	170	577	500	661
900	4026	330	1115/1075	1050/1020	1001/978	28/24	34/31	37.5	5	1197	643	655	217	170	577	500	813
1000	4026	410	1230/1175	1160/1120	1112/1078	28	37/31	40	5	1277	722	655	217	170	577	500	1018
1200	4027	470	1455/1405	1380/1340	1328/1295	32	40/34	45	5	1511	840	748	262	202	664	500	1501

DN	传动装置 Gear operator	D	D1	d	b	f	n-d0	L	H1	H2	L1	L2	L3	L4	L5	φ	A	4-s	B	E	F	h	重量 Weight (kg)
1400	4028	1675	1590	1530	46	5	36-φ43	530	1750	1150	884	334	305	238	790	500	310	33	1500	1360	1590	960	2895
1600	4028	1915	1820	1750	49	5	40-φ49	600	1870	1305	884	334	305	238	790	500	340	33	1600	1460	1700	1050	3655
1800	4028.5	2115	2020	1950	52	5	44-φ49	670	2125	1425	977	357.5	323	281	855	600	450	36	1900	1740	1990	1200	5210
2000	4029	2325	2230	2150	55	5	48-φ49	760	2280	1580	1059	397.5	345	307.5	903	600	480	36	2000	1850	2100	1323	6721
2200	4029.5	2550	2440	2370	58	6	52-φ56	580	2520	1710	1222	436	437.5	365.5	1075	800	400	36	2030	1830	2150	1410	7658
2400	40210	2760	2650	2570	62	6	56-φ56	750	2760	1880	1303	476	480	410.5	1191	800	490	45	2310	2120	2460	1470	10350
2600	40211	2960	2850	2780	66	6	60-φ56	900	3120	2010	1744	605	612	521	2024	1000	650	45	2400	2210	2540	1650	13708

U型法兰蝶阀 UFanged butterfly valve



D341X

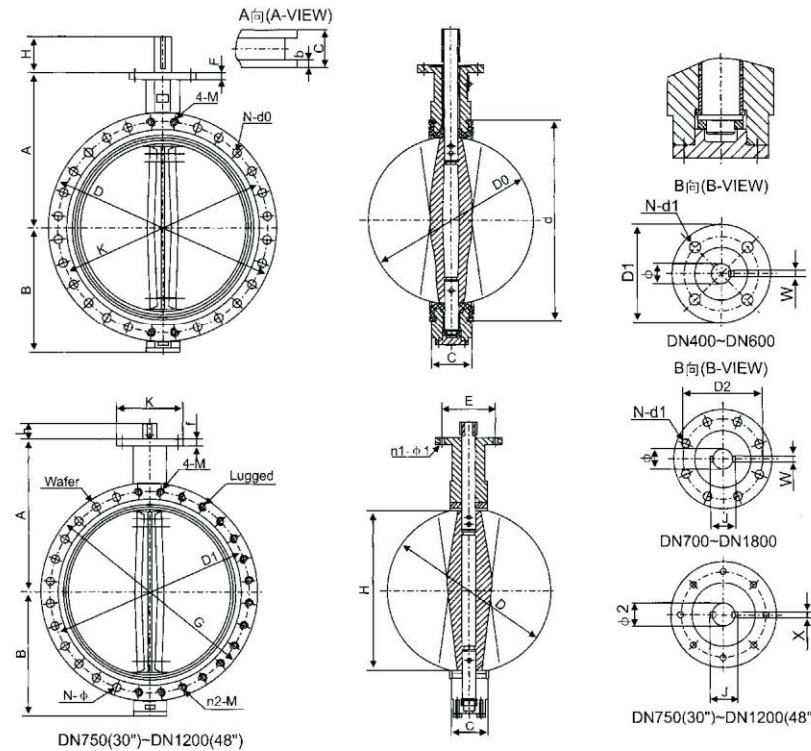

国标主要尺寸表 (PN16) GB Main dimensions (PN16)

DN (mm)	A	B	H	D0	C	D	K	d	N-d0
400	360	320	60	390	102	580	525	460	12-31
450	400	360	60	441	114	640	585	496	16-31
500	455	390	75	492	127	715	650	560	16-34
600	520	450	75	593	154	840	770	658	16-37
700	580	505	75	695	165	910	840	773	20-37
800	670	560	75	795	190	1025	950	872	20-41
900	705	630	110	865	203	1125	1050	987	24-41
1000	780	670	135	965	216	1255	1170	1073	24-44
1100	840	740	135	1065	251	1355	1270	1203	28-44
1200	910	790	150	1160	254	1485	1390	1302	28-50
1300	990	910	150	1260	279	1585	1490	1395	28-50
1400	1017	993	200	1359	279	1685	1590	1495	28-50
1500	1080	1040	200	1457	318	1820	1710	1638	28-57
1600	1150	1132	200	1556	318	1930	1820	1696	32-57
1800	1280	1270	280	1775	356	2130	2020	1893	36-57
2000	1390	1350	280	1955	406	2345	2230	2105	40-62

	A	B	H	D0	C	D	K	d	N-d0
4-M27	24.5	175	140	4-18	22	37.95	10	41.0	102
4-M27	25.5	175	140	4-18	22	42.86	12	45.9	141
4-M30	26.5	175	140	4-18	22	45.72	14	49.2	158
4-M33	30.0	210	165	4-22	22	53.98	16	58.0	232
4-M33	32.5	300	254	8-18	30	63.35	18	71.4	308
4-M36	35.0	300	254	8-18	30	70.00	20	79.0	420
4-M36	37.5	300	254	8-18	34	80.00	22	90.0	550
4-M39	40.0	300	254	8-18	34	90.00	25	100.0	895
4-M39	43.0	350	298	8-22	34	95.00	25	105.0	1170
4-M45	45.0	350	298	8-22	34	105.00	28	117.0	1350
8-M45	45.5	415	356	8-33	40	120.00	32	134.0	2350
8-M45	46.0	415	356	8-33	40	120.00	32	134.0	2650
8-M52	47.5	415	356	8-33	40	140.00	36	156.0	2920
8-M52	49.0	475	406	8-40	50	140.00	36	156.0	3140
8-M52	52.0	475	406	12-40	55	160.00	40	178.0	4890
8-M56	55.0	560	483	12-40	55	180.00	45	200.0	7120

伸缩法兰蝶阀 Flex flanged butterfly valve

简介 Brief

本蝶阀适用于温度 $\leq 80^{\circ}\text{C}$ ，用于石油、化工、食品、医药、轻纺、造纸、电力、给排水、气体管路上，作调节流量和截流介质的作用。具有补偿管道热胀冷缩的功能。

This butterfly valve is suitable for temperature $\leq 80^{\circ}\text{C}$, is used on petroleum, chemical industry foodstuff medicine gently the spinning and papermaking, power, plumbing and gas pipe route, and does the effect adjusted the volume of flow and dams a river the medium. Possess the bloated cold function that contracts of compensation pipeline heat.

特点 Features

- 设计新颖、合理、结构独特、重量轻、操作方便、启闭迅速。
- 本伸缩蝶阀既能起到调节流量和截流作用，又能补偿管道温差所产生的热胀冷缩功能，同时也便于安装和拆卸，为一阀多用产品。

- The design is new and original and reasonable and the structure is unique and is light in weight and operates makes things convenient for and it is rapid case to close.
- This stretch butterfly valve can act to adjust the volume of flow with damming a river the effect, to compensate that the pipeline difference in temperature is given rise to again hot expands to cool contracts the function, and but also being easy to at the same time install and dismantles, uses the product for one valve more.

安装注意事项 Installment matters needing attention

- 本蝶阀安装前必须清洗内腔杂物。
- 本阀可在一定范围内伸缩，因此安装前必须松开伸缩部位的密封垫压盖，然后将伸缩调节到所需位置锁紧管道螺栓后，再锁紧伸缩密封压盖，本阀不能超范围使用。

- This butterfly valve must rinse the cavity odds an d ends before the installation.
- These valve approve in the field flex, hence fasten must loosen pars contractilis steric seal gland, then should telescopic joint regulate to required position keeper conduit bolt post, anew keeper flex gland, these valve be incapable of exceed scope use up on.



SD341X-10C

主要零部件材料 Material of main parts

序号	零件名称 Part name	材料名称 Material name
1	阀体 Valve body	铸铁、球墨铸铁、铸钢、不锈钢 Cast iron, Nodular cast iron, cast steel and stainless steel
2	阀板 Valve board	球墨铸铁、铜合金、不锈钢 Nodular cast iron, Copper alloy and stainless steel
3	阀杆 Valve pole	2Cr13、45号钢 The 2Cr13 and No.45 steel
4	密封圈 Sealing-circle	耐磨橡胶、丁晴橡胶等 The fine rubber of wear-resisting rubber and NBR etc.
5	填料 Filler	丁晴橡胶O型垫等 The O mould pad of NBR

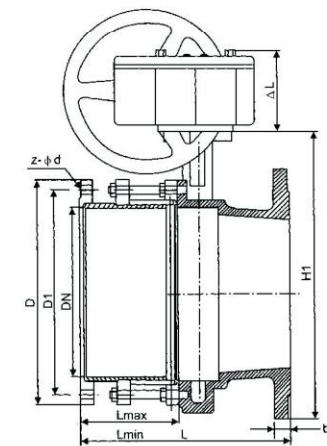

主要尺寸表 Main dimensions

DN (mm)	最短 Lmin Shortest	安装标准 L Install standard	最长 Lmax Longest	伸缩量 ΔL Stretching capacity	H1	H2	D1	D	z-φd	b
50	180	200	220	40 60	241	70	125	165	4-φ18	21
65	190	210	230		264	70	145	180	4-φ18	23
80	210	230	250		276	70	160	210	8-φ18	23
100	237	257	277		314	70	180	238	8-φ18	27
125	255	275	295		340	70	210	250	8-φ18	27
150	280	300	320		365	70	240	290	8-φ22	28
200	338	358	378		435	80	295	345	8-φ22	29
250	350	380	410		495	80	350	405	12-φ22	30
300	390	420	450		580	85	400	460	12-φ22	30
350	420	450	480		635	85	460	505	16-φ22	32
400	450	480	510		709	185	515	565	16-φ26	32
450	480	510	540		750	185	565	625	20-φ26	32
500	510	540	570		841	190	620	670	20-φ26	34
600	570	600	630		1021	190	725	780	20-φ30	36
700	630	660	690		1144	240	840	895	24-φ30	40
800	690	720	750		1263	240	950	1015	24-φ33	44

对夹式金属硬密封蝶阀

Wafer metal-seat butterfly valve

简介 Brief

对夹式金属硬密封蝶阀系吸收、消化国外技术，采用多层次金属密封结构，适用介质温度425℃冶金电力、石油化工、空气煤气、可燃气体、以及给排水等介质管道上作调节流量和截断流体的最佳装置。

Wafer metal-seat butterfly valve is the absorption, the digestion overseas technology, uses the multi-level metal seal structure, is suitable the medium temperature 425℃ metallurgy electric power, the petroleum chemical industry, the air gas, the flammable gas, as well as for medium pipeline on and so on the draining water makes the adjustment current capacity and the interruption fluid best installment.

特点 Features

- 1、蝶板密封圈为软硬层叠式金属片，具有金属硬密封和弹性密封的双重优点，无论在低温和高温情况下，均具有优良的密封性能。
- 2、采用三维偏心结构，阀座与蝶板几乎无摩擦，具有越关越紧的密封功能。
- 3、阀体密封面，采用堆焊钴基硬质合金，密封面耐磨损，使用寿命长。
- 4、结构独特，操作灵活、省力、方便、不受介质压力的高、低影响，密封性能可靠，使用寿命长。耐高温、耐腐蚀。
- 5、HPV三偏心(见下表图)

1. Butterfly board sealing enclosing to the soft hard one on top of another type metal piece, and possesses the double merit of metal close forcibly and elastic sealing, and no matter under low temperature and the high temperature circumstances, all possesses the fine close function.
2. Adopting three dimensions eccentric structure, the valve seat does not almost have the rub with the butterfly board, and possesses more the close function that the pass is tight more.
3. The valve body sealing surface adopts the surfacing cobalt base hard alloy, and sealing surface has the wear-resisting damage of face, and service life is long.
4. The structure is unique, and the operation is nimble and saves effort and makes things convenient for and not receiving the height of medium pressure and the low influence, it is reliable to seal up the function, and service life is long. High temperature, corrosion preventive.
5. Three-eccentric HPV (seeing down the table picture)

蝶阀双偏心“1”和“2”。“1”偏离管道中心。“2”偏离密封面中心。其主要目的是减少阀座与密封件之间大约15度行程的摩擦。

HPV增加了一个独特的偏心，“3”(倾斜锥形)，不但是凸轮作用，而且解除了在阀门启闭中密封件和两阀之间结合时的摩擦，从而增加了阀门的使用寿命。

Double-eccentric butterfly valve "1" and "2". "1" deviating the pipeline center. "2" deviating the sealing center. His major purpose is reducing the approximately rubs of route or distance of travel of 15 degrees between valve seat and the seal.

The HPV increased a unique partiality, "3" (tilting the conical contour), not only is the cam effect, but also separates except combining the rub of time at the valve opening and close between middle seal and two valves, thus the service life of valve was increased.

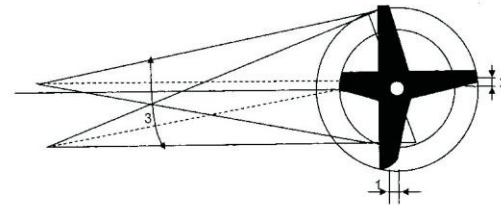

性能规范 Technical data

公称压力PN(MPa) Nominal pressure	1.0	1.6	2.5	4.0	
试验压力 Testing pressure	强度 Intensity tria	1.5	2.4	3.8	6.0
	密封 Sealing	1.1	1.76	2.75	4.4
适用温度℃ Working temperature	425℃				
适用介质 Suitable mediums	水、蒸汽、煤气、油品、热空气、腐蚀等介质。 Water, steam, coal gas, oil article, hot air and corrosiveness etc.				

主要零部件材料 Material of main parts

阀体 蝶阀 Valve body and butterfly valve	阀杆 Valve pole	密封圈 Sealing ring	填料 Filler
铸钢、不锈钢 Cast steel and stainless steel	不锈钢 Stainless steel	不锈钢 Stainless steel	柔性石墨、聚四氟 Flexibility graphite and PTFE
铬钼钢 Chromium molybdenum steel	铬钼钢 Chromium molybdenum steel		

注：可根据用户需要，选配电动、气动装置。

Note: Can select and provided electric actuator or pneumatic actuator device according to the user's need.

对夹式金属硬密封蝶阀

Wafer metal-seat butterfly valve

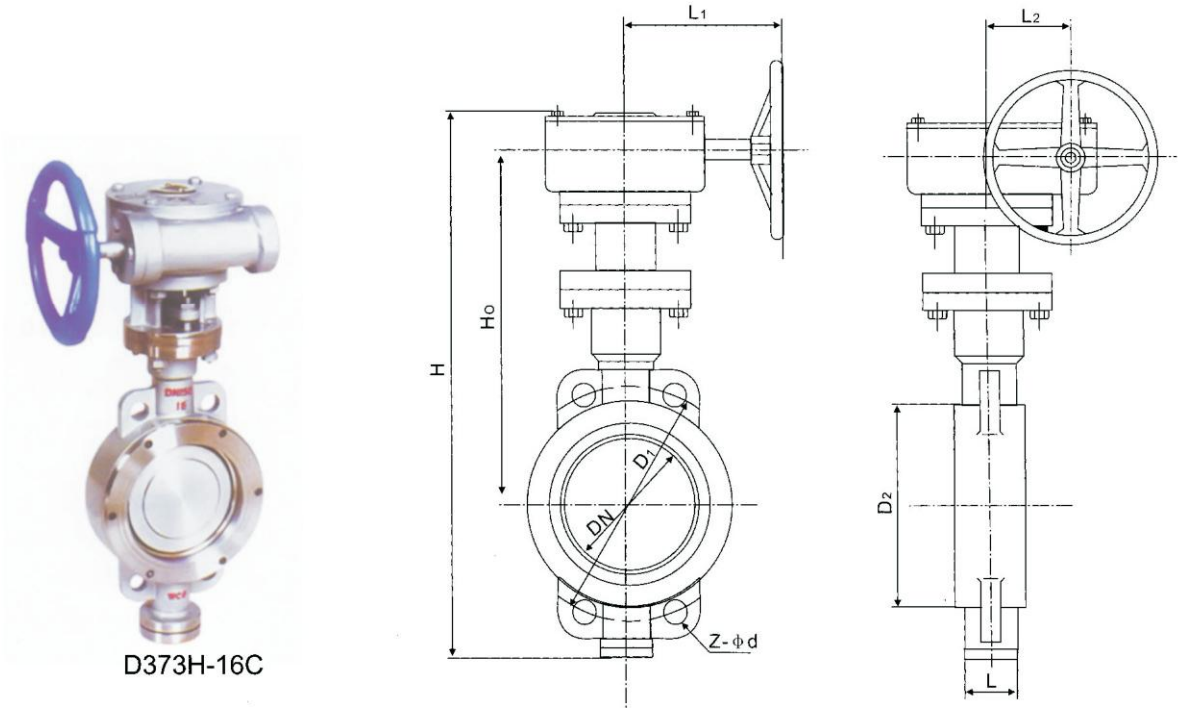

D373H-16C

主要尺寸表 Main dimensions

DN (mm)	L	H	Ho	PN1.0MPa		PN1.6MPa		PN2.5MPa	
				D1	z-φd	D1	z-φd	D1	z-φd
50	43	220	160	125	4-φ18	125	4-φ18	125	4-φ18
65	46	220	175	145	4-φ18	145	4-φ18	145	4-φ18
80	49	280	182	160	4-φ18	160	4-φ18	160	4-φ18
100	64	320	192	180	4-φ18	180	4-φ18	190	4-φ23
125	70	345	200	210	4-φ18	210	4-φ18	220	4-φ25
150	70	385	230	240	4-φ23	240	4-φ23	250	4-φ25
200	71	471	297	295	4-φ23	295	4-φ23	310	4-φ25
250	76	533	327	350	4-φ23	355	4-φ25	370	4-φ30
300	83	606	364	400	4-φ23	410	4-φ25	430	4-φ30
350	92	694	404	460	4-φ23	470	4-φ25	490	4-φ34
400	102	757	444	515	4-φ25	525	4-φ30	550	4-φ34
450	114	814	472	565	4-φ25	585	4-φ30	600	4-φ34
500	127	902	522	620	4-φ25	650	4-φ34	660	4-φ41
600	154	606	1180	725	4-φ30	770	4-φ36	770	4-φ41
700	165	738	1460	840	4-φ30	840	4-φ41	875	4-φ48
800	190	801	1588	950	4-φ34	950	4-φ41	990	4-φ48
900	203	989	1856	1050	4-φ34	1050	4-φ41	1090	4-φ54
1000	216	1053	1990	1160	4-φ34	1170	4-φ48	1210	4-φ58
1200	254	1162	2190	1380	4-φ41	1390	4-φ54	1420	4-φ58
1400	390	1310	2306	1590	4-φ48	1590	4-φ54	1640	4-φ65
1600	440	1436	2680	1820	4-φ54	1820	4-φ58	-	-
1800	490	1579	2917	2020	4-φ54	2020	4-φ56	-	-
2000	540	1723	3174	2230	4-φ54	2230	4-φ62	-	-

法兰连接金属硬密封蝶阀

Flang connected metal-seat butterfly valve

简介 Brief

本蝶阀适用于石油、化工、食品、医药、冶金、船舶、造纸、工业环保、给排水、高层建筑管道上，可在多种腐蚀性、非腐蚀性的气体、液体、浆流体及固体粉末管线和容器作启闭或调节介质流量之用。

Butterfly valve for the petroleum, chemical, food, medicine, metallurgy, shipbuilding, paper, industrial environmental protection, water supply and drainage, on high-level pipeline architecture can be in a variety of corrosive, non-corrosive gases, liquids, fluids and solid powder loaded pipelines and containers for the headstock or adjust the medium flow purposes.

特点 Features

1. 蝶板密封圈为软硬层叠式金属片，具有金属硬密封和弹性密封的双重优点，无论在低温和高温的情况下，均具有优良的密封性能。
 2. 采用三维偏心结构，阀座与蝶板几乎无摩擦，具有越关越紧的密封功能。
 3. 阀体密封面，采用堆焊不锈钢、钴基硬质合金，密封面耐磨损，使用寿命长。
 4. 结构独特，操作灵活、省力、方便、不受戒指压力的高、低影响，密封性能可靠。
1. Butterfly plate ring for soft and hard metal sheets stacked with metal hard sealing and sealing of the dual advantage of flexibility in terms of low temperature and high-temperature circumstances, have Excellent sealing performance.
 2. Using three-dimensional eccentric structure, Butterfly Valve base plate with almost no friction, with more clearance seal function is tightening.
 3. Valve body sealing surface, the use of welding stainless steel, cobalt-based alloy, sealing surface wear-resistant, long service life.
 4. Unique structure, operation flexibility, labor-saving, convenient and free from the pressure ring high-and low- impact, reliable sealing performance.

性能规范 Technical data

公称通径 DN(mm) Nominal diameter	50~2000		
公称压力 PN(MPa) Nominal pressure	1.0	2.5	
试验压力 Testing pressure	壳体 Shell	1.5	3.75
	密封 Sealing	1.1	2.75
适用温度 °C Working temperature	-40~+425		
适用介质 Suitable mediums	水、海水、气体、油、酸碱类等 Water, sea water, air, oils, acids alkali etc.		

主要零部件材料 Material of main parts

零件名称 Part name	材料名称 Material name
阀体 Valve body	铸钢、不锈钢、铬镍钼钛钢 Steel, stainless steel, Ti-Cr-Ni-Mo steel
阀板 Valve board	不锈钢、铬镍钼钛钢 Stainless steel, Ti-Cr-Ni-Mo steel
阀杆 Valve pole	2Cr13、不锈钢、铬镍钼钛钢 2Cr13, stainless steel, Ti-Cr-Ni-Mo steel
填料 Padding	氟塑料、柔性石墨 Fluorine plastic, flexible graphite

法兰连接金属硬密封蝶阀

Flang connected metal-seat butterfly valve

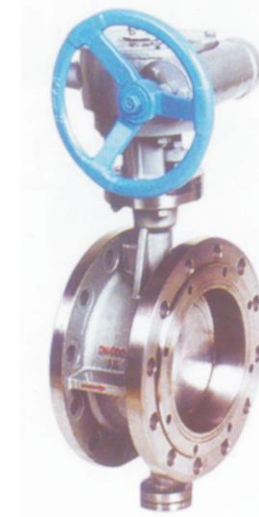

D343H-16C

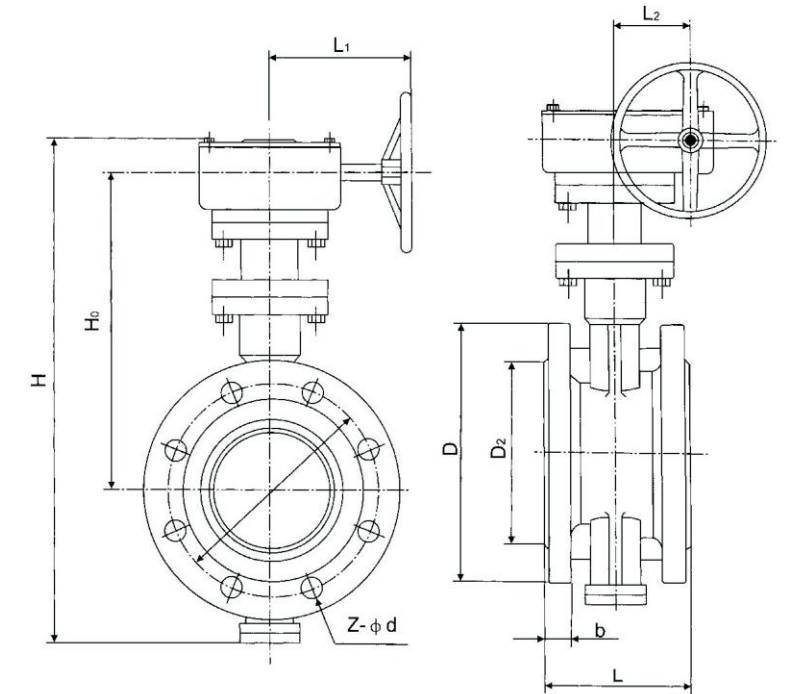

主要尺寸表 Main dimensions

DN (mm)	L	H	H ₀	PN1.0MPa				PN1.6MPa				PN2.5MPa			
				D	D ₁	b	z-φd	D	D ₁	b	z-φd	D	D ₁	b	z-φd
50	108	220	160	165	125	20	4-φ18	165	125	16	4-φ18	160	125	20	4-φ18
65	112	220	175	185	145	20	4-φ18	185	145	18	4-φ18	180	145	22	8-φ18
80	114	320	186	195	160	22	4-φ18	200	160	20	8-φ18	195	160	22	8-φ18
100	127	320	192	215	180	22	8-φ18	220	180	20	8-φ18	230	190	24	8-φ23
125	140	345	200	245	210	24	8-φ18	250	210	22	8-φ18	270	220	28	8-φ25
150	140	385	230	280	240	24	8-φ23	285	240	24	8-φ23	300	250	30	8-φ25
200	152	471	297	335	295	26	8-φ23	340	295	26	12-φ23	360	310	34	12-φ25
250	165	533	327	390	350	28	12-φ23	405	355	30	12-φ25	425	370	36	12-φ30
300	178	606	364	440	400	28	12-φ23	460	410	30	12-φ26	485	430	40	16-φ30
350	190	694	404	500	460	30	16-φ23	520	470	34	16-φ26	550	490	44	16-φ34
400	216	757	444	565	515	32	16-φ25	580	545	36	16-φ30	610	550	48	16-φ34
450	222	814	472	615	565	32	20-φ25	640	585	40	20-φ30	660	600	50	20-φ34
500	229	902	522	670	620	34	20-φ25	715	650	44	20-φ34	730	660	52	20-φ41
600	267	1048	608	780	725	36	20-φ30	840	770	48	20-φ41	840	770	56	20-φ41
700	292	1273	795	895	840	40	24-φ30	910	840	50	24-φ41	955	875	60	24-φ48
800	318	1382	835	1010	950	44	24-φ34	1020	950	52	24-φ41	1070	990	64	24-φ48
900	330	1497	885	1110	1050	46	28-φ34	1120	1050	54	28-φ41	1180	1090	66	28-φ54
1000	410	1617	945	1220	1160	50	28-φ34	1255	1170	56	28-φ48	1305	1210	68	28-φ58
1200	470	2180	1160	1455	1380	56	32-φ41	1485	1390	58	32-φ54	1525	1420	72	32-φ68
1400	530	2300	1310	1675	1590	62	36-φ48	1685	1590	60	36-φ54	1750	1640	78	36-φ65
1600	600	2670	1436	1915	1820	68	40-φ54	1930	1820	68	40-φ58	-	-	-	-
1800	697	2920	1580	2115	2020	72	44-φ54	2130	2020	50	44-φ56	-	-	-	-
2000	760	3170	1724	2325	2230	74	46-φ54	2345	2230	54	48-φ62	-	-	-	-

对焊式金属硬密封蝶阀

Mutual weld type metal hard sealing butterfly valve

主要特点及用途 Main characteristic and application

- 1、采用三偏心蝶阀的一个过程式阀门，此设计使阀门为高温、高压、防火应用中气泡密封的理想硬密封的理想硬密封蝶阀。
 - 2、由于采用焊接结构，使阀门与此同时管道平面达到永久性的零泄漏。
 - 3、此阀无法兰，对管道和保温包扎带来很大方便和美观。
- 1、Adopt one processing valve of tri-eccentric butterfly valve, this design makes bubble seal in the high-temp, high-pressure, fire-proof, it is the ideal hard sealing butterfly valve.
 - 2、Adopt the welding structure, make the valve and pipe level reaches the nonvolatile zero leakage.
 - 3、This valve hasn't flange, it is convenient and graceful to pipe and binding tape keeping warmth.

性能规范 Technical data

公称压力PN(MPa) Nominal pressure	试验压力 (MPa) Test that pressure	
	壳体强度试验 Body shell test	密封试验 Seal test
1.0	1.5	1.1
1.6	2.4	1.8
2.5	3.8	2.8
4.0	6.0	4.4

主要零部件材料 Material of main parts

产品类型 Product type	零件名称 Part name			
	阀体 Valve body	蝶板 Disc	阀轴 Valve shaft	密封面 Sealing surface
碳钢型 (C) Carbon steel	WCB	WCB	铬不锈钢 Chrome stainless steel	铁基合金 Iron base alloy
合金钢型 (I) Alloy steel	C5	C5	铬钼钒钢 Chrome molybdenum vanadium steel	钴基合金 Cobalt base alloy
不锈钢高温型 (PI) Stainless steel high temperature	高镍铬钢 High nickel chrome steel	高镍铬钢 High nickel chrome steel	铬镍钼钛钢 Chrome nickel molybdenum titanium steel	钴钨合金 Cobalt tungsten base alloy

主要尺寸表和重量 Main dimensions and weight

PN(MPa)	DN (mm)	L	H1	H2	H	D0	重量(kg) Weight
1.6	80	180	186	90	230	160	27
	100	190	195	100	239	160	34
	125	200	208	113	252	160	41
	150	210	240	130	284	160	43
	200	230	260	205	307	160	81
	250	250	295	235	337	200	102
	300	270	340	275	392	200	132
	350	290	383	309	435	250	164
	400	310	427	346	481	300	193
	450	330	467	392	521	400	238
	500	350	499	427	568	400	302
	600	390	618	509	689	500	457
	700	430	745	572	903	350*	810
	800	470	809	638	967	350*	1093
	900	510	999	700	1175	450*	1410
	1000	550	1064	765	1240	450*	1870
	1200	630	1174	860	1350	450*	2082
	1400	710	1324	986	1450	600*	2850
1600	790	1450	1106	1600	600*	4235	
1800	870	1595	1226	1720	600*	5346	
2000	950	1740	1345	1860	600*	7328	



D363H-16C

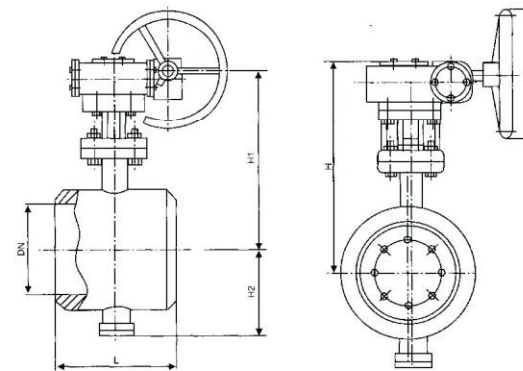

硬密封偏心伸缩法兰蝶阀

Hard sealed eccentric telescopic flange butterfly valve

简介 Brief

硬密封偏心结构伸缩型法兰蝶阀是集法兰蝶阀、伸缩节于一体的新颖结构，以其良好的使用性能而深受用户的信赖。本产品主要适用于水厂、电厂、钢厂、石油化工、食品医药、轻纺、造纸等系统给排水用，可作为老管道改造、维修和配套阀门的换代，尤其适用于水管路中作为调节和截流设备使用。

Hard sealing eccentric structure telescopic flange butterfly valve is a set of flange butterfly valve, expansion joint in one of the novel structure, with its good performance and trusted by the user. This product is mainly used in waterworks, power plants, steel mills, oil and chemical industry, medicine, food, textile, paper and other system used for water supply and drainage, as the transformation of the old pipeline, maintenance and supporting the valve replacement, especially in water as a regulator and the use of closure devices.

特点 Features

- 1、设计合理，结构紧凑，90°旋转，启闭灵活。
- 2、采用偏心结构，密封副之间自动建立密封比压，减少密封面的摩擦，延长阀门使用寿命。
- 3、密封结构无机械连接，能适应较恶劣的工况。完全密封，泄露为零。阀座抗冲刷能力强。
- 4、伸缩部位密封性能可靠，安装拆卸方便。
- 5、能适应一定量的管路错位和倾斜，管路连接不需焊接。

- 1、Reasonable design, compact structure, 90° rotation, opening and closing flexible.
- 2、The use of eccentric structure, the seal between the automatic seal, reducing the friction of the sealing surface, to extend the life of the valve.
- 3、Sealing structure without mechanical connection, can adapt to the harsh conditions. Completely sealed, leaked to zero. Strong anti flush valve seat.
- 4、Sealing performance is reliable, easy to install and remove.
- 5、Can adapt to a certain amount of pipeline dislocation and tilt, pipeline connection does not need to weld.

性能规范 Technical data

公称口径 DN(mm) Nominal diameter	300-2000	
公称压力PN(MPa) Nominal pressure	1.0	
试验压力 Testing pressure	壳体 Shell	1.5
	密封 Sealing	1.1
适用温度℃ Working temperature	-15~+425	
适用介质 Suitable mediums	饮用水、污水、海水等 Drinking water, sewage, sea water, etc.	

主要零部件材料 Material of main parts

零件名称 Part name	材料 Material
阀体 Valve body	球墨铸铁、灰铸铁 Ductile iron, grey cast iron
阀板 Valve disc	球墨铸铁 Ductile iron
转轴 Shaft	不锈钢 Stainless steel
轴套 Axle sleeve	铸铜、钢背F4 Cast copper, steel back F4
阀板密封圈 Valve plate seal ring	各种橡胶 All kinds of rubber
填料 Packing	各种橡胶 All kinds of rubber



SD343XH-10C

软密封偏心伸缩法兰蝶阀

Soft sealed eccentric telescopic flange butterfly valve

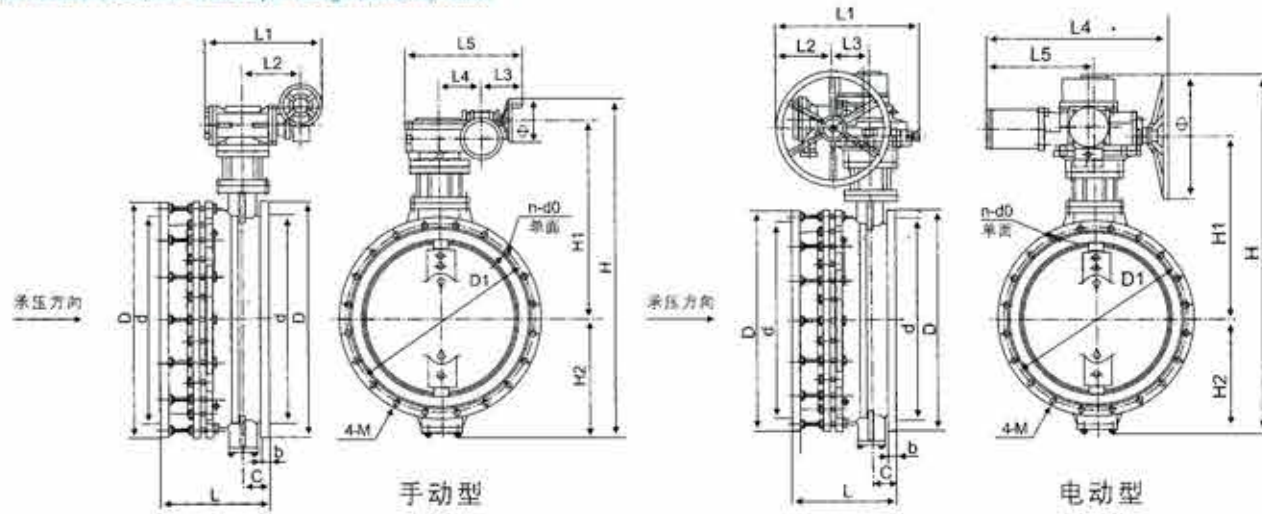

SD343X主要尺寸表 Main dimensions

DN (mm)	手动装置	D	D1	d	b	C	L			n-d0	4-M	H	H1	H2	L1	L2	L3	L4	L5	φ	重量(kg) Weight
							L0	Lmax	Lmin												
300	3D-30/250	445	400	370	28	57	282	302	252	8-23	M20	969	542	267	449	178	254	104	473	300	148
350	3D-30/250	505	460	429	30	64	301	321	271	12-23	M20	1048	583	315	449	178	254	104	473	300	188
400	3D-30/250	565	515	480	32	70	313	333	283	12-28	M24	1120	620	350	449	178	254	104	473	300	237
450	3D-30/250	615	565	530	32	76	334	354	304	16-28	M24	1190	667	373	449	178	254	104	473	300	268
500	3D-30/400	670	620	582	34	76	346	366	316	16-28	M24	1280	702	428	486	196	254	130	528	300	289
600	3D-60/800	780	725	682	36	89	398	418	368	16-31	M27	1409	759	450	627	244	245	162	596	400	480
700	3D-60/800	895	840	794	40	115	425	445	395	20-31	M27	1613	885	528	627	244	245	162	596	400	615
800	3D-120/1500	1015	950	901	44	120	455	475	425	20-34	M30	1736	1013	573	635	270	295	196	711	300	818
900	3D-120/1500	1115	1050	1001	46	120	485	505	455	24-34	M30	1860	1071	639	635	270	295	196	711	300	956
1000	3D-120/1500	1230	1160	1112	50	150	495	515	465	24-37	M33	2107	1234	723	955	455	296	295	807	300	1277
1200	3D-120/1500	1455	1380	1328	56	175	542	562	512	28-40	M36	2326	1343	833	955	455	296	295	807	300	1764
1400	3D-200/4000	1675	1590	1530	62	195	612	632	582	32-43	M39	2996	1668	1078	1270	598	387	414	1089	500	4280
1600	3D-200/4000	1915	1820	1750	68	220	640	660	610	36-49	M45	3246	1778	1218	1270	598	387	414	1089	500	4953
1800	3D-200/12000	2115	2020	1950	70	245	710	730	680	40-49	M45	3720	2044	1426	1625	745	387	602	1399	500	7416
2000	3D-600/12000	2325	2230	2150	74	270	775	795	745	44-49	M45	3851	2115	1486	1630	750	417	602	1430	500	9372

SD943X主要尺寸表 Main dimensions

DN (mm)	电动装置	D	D1	d	b	C	L			n-d0	4-M	H	H1	H2	L1	L2	L3	L4	L5	φ	重量(kg) Weight
							L0	Lmax	Lmin												
300	802.250-1	445	400	370	28	57	282	302	252	8-23	M20	1008	531	267	473	148	140	625	365	500	181
350	802.250-1	505	460	429	30	64	301	321	271	12-23	M20	1097	572	315	473	148	140	625	365	500	221
400	802.250-1	565	515	480	32	70	313	333	283	12-28	M24	1169	609	350	473	148	140	625	365	500	270
450	802.250-1	615	565	530	32	76	334	354	304	16-28	M24	1219	636	373	473	148	140	625	365	500	301
500	802.500-0.5	670	620	582	34	76	346	366	316	16-28	M24	1318	680	428	473	148	140	625	365	500	307
600	802.500-0.5	780	725	682	36	89	398	418	368	16-31	M27	1380	720	450	473	148	140	625	365	500	446
700	802.1000-0.2	895	840	794	40	115	425	445	395	20-31	M27	1839	829	528	590	148	140	696	230	500	691
800	ZA36024-3D1500	1015	950	901	44	120	455	475	425	20-34	M30	1663	942	573	740	215	196	1028	612	305	910
900	ZA36024-3D1500	1115	1050	1001	46	120	485	505	455	24-34	M30	1787	1000	639	740	215	196	1028	612	305	1048
1000	ZA36024-3D1500	1230	1160	1112	50	150	495	515	465	24-37	M33	1983	1108	723	970	310	295	1123	612	305	1355
1200	ZA312024-3D2500	1455	1380	1328	56	175	542	562	512	28-40	M36	2202	1217	833	970	310	295	1123	612	305	1842
1400	ZA416024-3D4000	1675	1590	1530	62	195	612	632	582	32-43	M39	2861	1472	1078	1224	422	414	1452	750	457	4345
1600	ZA416024-3D4000	1915	1820	1750	68	220	640	660	610	36-49	M45	3111	1582	1218	1224	422	414	1452	750	457	4992
1800	ZA424024-3D12000	2115	2020	1950	70	245	710	730	680	40-49	M45	3585	1848	1426	1640	630	602	1762	750	457	7360
2000	ZA424024-3D12000	2325	2230	2150	74	270	775	795	745	44-49	M45	3672	1875	1486	1630	602	602	1762	750	457	9050